

**LA TROBE  
UNIVERSITY**
**HAVE THE  
TIME OF  
YOUR LIFE**

## Want to experience one of the world's most unique destinations while studying at one of Australia's most beautiful universities?

One of Australia's leading universities, La Trobe University has an international reputation for academic excellence and innovation. An Exchange or Study Abroad experience with us can change your life.

### CHOOSE YOUR SUBJECTS

Our study offering is diverse and covers the following areas:

- Accounting and business
- Agricultural and environmental sciences
- Allied health and rehabilitation
- Arts and social sciences
- Asian studies and languages
- Biological sciences
- Counselling and social work
- Economics and finance
- Education and teaching
- Engineering
- European studies and languages
- Health management
- Health sciences
- Historical and cultural studies
- Human biosciences
- Information technology
- International relations
- International development
- Journalism, media and communications
- Law
- Marketing and management
- Medical and psychological sciences
- Nursing and midwifery
- Outdoor and environmental education
- Physical, chemical and mathematical sciences
- Psychology
- Public health
- Urban planning
- Visual and creative arts.

You can find subjects by using the Subject Database:  
[latrobe.edu.au/students/subjects](http://latrobe.edu.au/students/subjects)



### MELBOURNE CAMPUS

**Distance from Melbourne Campus (Bundoora) to Melbourne (city): 14 km (8.7 miles)**

**Student population: 24 835**

La Trobe University's Melbourne Campus is one of the most beautiful university campuses in Australia. Spanning 267 hectares (660 acres) of stunning parkland and waterways, and including a major wildlife sanctuary, the Campus has many beautiful spots for students to relax and have fun.

The Campus also includes:

- a bookshop
- a hairdresser
- a travel agent
- a jewellery store
- printing services
- a weekly market
- banks
- a bakery
- a post office
- a theatre and cinema
- a convenience store
- and childcare.

Restaurants and cafés on campus provide a range of food options including modern Australian, European, Chinese, Japanese, Indian, vegetarian and halal. Travel between the Campus and central Melbourne takes about 30 to 40 minutes by bus or car, or at least 50 minutes by tram.

Find out more about living in Melbourne at:  
[studymelbourne.vic.gov.au](http://studymelbourne.vic.gov.au)



### BENDIGO CAMPUS

**Distance to Melbourne (city): 150 km (93 miles)**

**Distance to central Bendigo: 3 km (1.86 miles)**

**Student population: 5071**

This vibrant and progressive regional city maintains strong links to its past. As one of the centres of Australia's 1850s gold rush, Bendigo is filled with a rich sense of history and heritage. Beautifully restored buildings line its wide streets, which also feature many fantastic restaurants and cafés. All major forms of transport – rail, road and air – link Bendigo directly to Melbourne and other major regions of Victoria.

The Bendigo Campus, La Trobe's second largest campus, is spread over 33 hectares (81 acres) of native Australian bushland and is a 1.5-hour drive from Melbourne. The compact size of the Campus makes it easy to find your way around, establish new friendships and feel part of the University community. Students at Bendigo have access to a full range of services and facilities.

Buses run between the University, city, train station and other locations on a regular basis.





Twelve Apostles, Great Ocean Road



Melbourne Campus

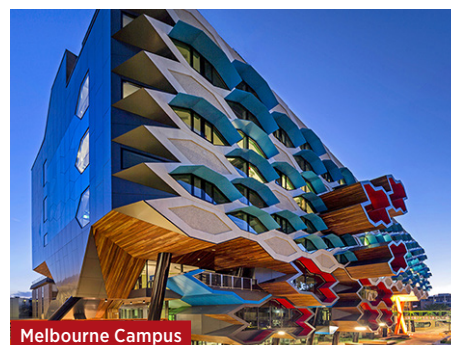

Melbourne Campus

## PRE-ORIENTATION TRIP

Kick off your studies by joining us on the Pre-Orientation Trip.

What better way to ease into Aussie life than a weekend escape to the spectacular coastline along the Great Ocean Road? Eat Aussie tucker, learn to surf, see the iconic Twelve Apostles – and there's even a good chance you'll run into a koala or two! This is a fantastic opportunity for you to make some friends before the start of the official Orientation.

Information about this trip is provided to you once you accept your offer. Limited spaces are available.

## STUDY ABROAD FEES

Tuition fees for the Study Abroad program are based on a full-time study load of 60 credit points per semester.

The tuition fees in 2017\* (Student Amenity Fee included) are:

- AUD \$9,000 for one semester
- AUD \$18,000 for two semesters (a full academic year)
- AUD \$4,400 for the Edge of the Outback photography short program (this program fee is subject to change in 2017).

Limited scholarships are available each semester, for more information visit:  
[latrobe.edu.au/study/costs/international](http://latrobe.edu.au/study/costs/international)

## EXCHANGE FEES

If your home institution has an exchange agreement with La Trobe University, and you are nominated for an exchange placement, no fees will apply.

To see the La Trobe University exchange partner list, visit:  
[latrobe.edu.au/students/exchange/partners](http://latrobe.edu.au/students/exchange/partners)

## INTERNSHIPS

Boost your Study Abroad or Exchange adventure by combining your studies with a practical placement.

We facilitate internships\*\* in the areas of communications, media and journalism.

Check out our other unique intern subjects by visiting:

[latrobe.edu.au/study/exchange-and-study-abroad/courses-and-subjects](http://latrobe.edu.au/study/exchange-and-study-abroad/courses-and-subjects)

## VOLUNTEERING OPPORTUNITIES

A range of volunteering opportunities are available at La Trobe, including our very own wildlife sanctuary on Melbourne campus.

Volunteering opportunities at La Trobe:  
[latrobe.edu.au/students/international/support/activities/volunteering](http://latrobe.edu.au/students/international/support/activities/volunteering)

La Trobe Wildlife Sanctuary:  
[latrobe.edu.au/wildlife/get-involved/volunteering](http://latrobe.edu.au/wildlife/get-involved/volunteering)

## ENTRY REQUIREMENTS

As a general guide, La Trobe University requires a C average for entry into the Study Abroad and Exchange program (GPA 2.5). Entry to individual subjects may depend on prerequisites and class limitations. If you are currently completing, or have just completed your last year of secondary/high school, you will be required to meet the minimum academic entry requirements for the undergraduate degree program that best matches your Study Abroad program.

If you're not enrolled in a university overseas, you will only be eligible for entry into first-year subjects or subjects with no prerequisites.

You must also provide evidence of your English language proficiency.

For more information on English language requirements for your country, visit:  
[latrobe.edu.au/study/how-to-apply/international/english-and-academic-requirements](http://latrobe.edu.au/study/how-to-apply/international/english-and-academic-requirements)

## FOR FURTHER INFORMATION

Exchange students and fee paying Study Abroad students (partner based and direct applicants)  
[studyabroad@latrobe.edu.au](mailto:studyabroad@latrobe.edu.au)

Students applying through an education agent:  
[LTIAE@latrobe.edu.au](mailto:LTIAE@latrobe.edu.au)

T +61 3 9479 2112

[latrobe.edu.au/study/exchange-and-study-abroad](http://latrobe.edu.au/study/exchange-and-study-abroad)

\* The University reserves the right to vary fees on an annual basis.

\*\* Internships are subject to availability in any given semester and suitability of your home university degree study area. Internships are for credit only and not paid.