



Lakehead  
UNIVERSITY

A TRULY  
**CANADIAN**  
**EXPERIENCE**

**2021-2022**  
INTERNATIONAL VIEWBOOK

THUNDER BAY & ORILLIA, ONTARIO, CANADA  
[LAKEHEADU.CA/INTERNATIONAL](https://lakeheadu.ca/international)



# IMAGINE A UNIVERSITY...

Where your professors know your name. Where the peers and student services staff you meet on day one will be the familiar faces you recognize on day two, and soon become lifelong friends and mentors. Imagine a university where, instead of walking into a big lecture hall full of strangers, you will walk into an academic community where your input matters.

Where your success counts.

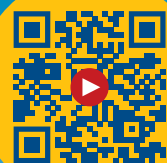

## WELCOME TO LAKEHEAD



UNDERGRADUATE  
**RESEARCH**  
University in Canada  
(RESEARCH Infosource  
2015, 2016, 2017, 2018, 2019)



**TOP**  
CANADIAN UNIVERSITY  
UNDER 10,000 STUDENTS  
IN THE WORLD  
(Times Higher Education  
Global Rankings 2020)

**96.7%**  
EMPLOYED WITHIN  
**2 YEARS OF**  
**GRADUATION**



CANADA'S  
**TOP 10**  
UNIVERSITIES  
(Primarily Undergraduate,  
Maclean's Magazine 2020)



**SMALL CLASS SIZES**  
STUDENTS TO PROFESSORS  
**15:1** **13:1**  
Thunder Bay Campus Orillia Campus

**70+**

NATIONS REPRESENTED  
**IN LAKEHEAD'S**  
**STUDENT BODY**



# A TRULY CANADIAN EXPERIENCE

Wherever you are in the world, you will have your own ideas about what represents Canada: vast and scenic landscapes, clean air and water, globally-recognized academic institutions, hockey, maple syrup, the best of all four seasons (including snow), multicultural cities with people from many different countries, opportunities to work and build your career, and even the possibility to start a new life as a Canadian citizen. As a Lakehead student, we hope to be part of the many moments that will become your Truly Canadian Experience.



Browsing through this book, look for this symbol to be introduced to the stories of Lakehead students and graduates and all the ways Lakehead University represents for them "A Truly Canadian Experience."

## TABLE OF CONTENTS

About Lakehead	4 - 15	Applying	50 - 55
The Student Experience	16 - 31	English Language Centre	56
Cooperative Education & Employment	28 - 29	Maple Leaf World Schools	57
Scholarships & Fees	30 - 31	Canadians Abroad	58 - 59
Our Programs	32 - 47	Campus Map	60

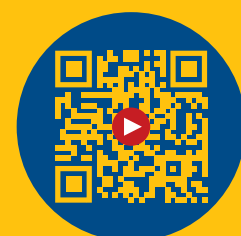

See, hear and experience Lakehead through videos you can access in this book wherever these codes appear.



All of the photos in this book showcase real Lakehead students, staff, and faculty, past and present.



Photo: Daniela Weaver

## LAKEHEAD UNIVERSITY AT A GLANCE

Founded in **1965**

**90%** of classes have fewer than **60 students**

**85+** Programs

**25+** Research Labs, Centres & Institutes

Home to **10+** Canada Research Chairs

**8,500+** Students at Lakehead

**1,500+** International Students

**65,520** Alumni from **97 countries**

**70+ countries** represented in Lakehead's student body





# OUR GLOBAL COMMUNITY

## INVITING THE WORLD TO LAKEHEAD. BRINGING LAKEHEAD TO THE WORLD.

Lakehead University is small enough to offer the personalized approach to education and supports that allows you to thrive. And Lakehead is big enough to embody a truly global perspective. Not only does our student body come from over 70 nations around the world, we also enable our students to study abroad, take part in international placements and field school opportunities.

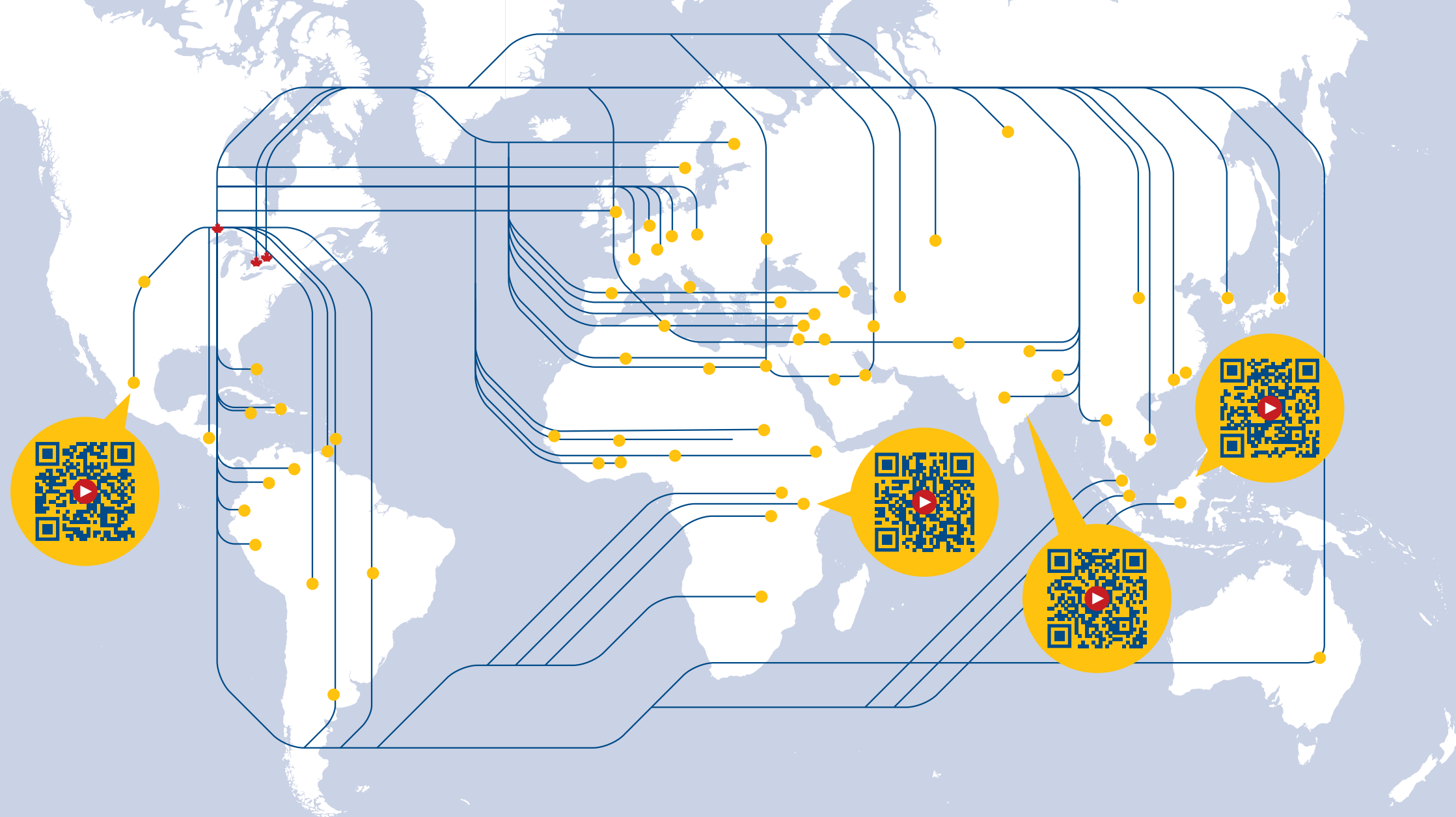

**Ankit Raj  
Patna, India**

*Master of Science (Computer Science)  
Graduate*  
**IT Developer / Analyst, Canada Revenue  
Agency in Ottawa**

"Coming from a big, over-populated city in India, it was refreshing for me to move to a city that offers a perfect balance between 'Living in the City' and 'Living in the Wild'. I am a nature enthusiast, and I love to hike and seek opportunities to stay close to nature. Thunder Bay provided everything I wanted in a beautiful package of academic and recreational activities. Another major reason I chose Lakehead was for its co-op program. Lakehead gave me a better insight into the Canadian job market which helped me achieve my professional goals."



**Bolu Fabanwo  
Lagos, Nigeria**

*Honours Bachelor of Commerce Graduate*  
► Recipient of the 2019 Simcoe County  
Immigrant Mentor Award  
► Founder of Lakehead University Multicultural  
Association (Orillia)

"Back when I started my degree, my roommate, Eric, went out of his way to help me get involved and meet new people. He inspired me to try to do the same for others. I got really involved in student life, clubs and athletics. This helped me build connections with staff, faculty and other students. It has made me more comfortable talking to people. My perspective on life has also changed, and I really think that's because of all the different people I've met. I've been exposed to new cultures and built so many connections, and that's really broadened my horizons."



**Mariam Abdulla Alameri  
Abu Dhabi, United Arab Emirates**

*Bachelor of Engineering (Mechanical)  
Graduate*  
**Mechanical Engineer in the Peaceful Nuclear  
Energy Sector, Abu Dhabi**  
► Official Member of the UAE Women's Ice  
Hockey Team

"The friends I made since the first day I stepped into Lakehead are still in touch with me even though I'm on the other side of the world. I think that is because Thunder Bay is a place that reinforces social connections and bonds in a way that can't be done in busy cities. The amount of nature that surrounds the campus is amazing. I remember that even on the busiest days, the walk from my dorm to my class by Lake Tamblyn would be such a stress relief and I would soak all the fresh air in."



**Michelle Parker  
Kampung Kopimpinan, Malaysia**

*Honours Bachelor of Environmental Science  
(Earth Science) Student*

- MITACS Research Award Winner

"Thanks to the MITACS award, my project on fire and the application of wood ash effects on stabilized soil will be funded. This research experience will familiarize me with methods used in the field and lab to collect data. I will be able to learn statistical methods beyond what I've learned in my undergraduate studies. All these new experiences will contribute to improving my research career. This project will be my honours thesis and my first independent research project, which I'll present to the Geology department. Depending on the results, I may even share the work at a scientific conference."



**Yibo Shen  
Beijing, China**

*Honours Bachelor of Arts & Science  
(Environmental Sustainability) Student*

- International Student Assistant hosting social events for short-term language program students

"When I arrived in Canada, the first thing I noticed was the environment, the air quality, the biodiversity. I feel good here. This year, I had the opportunity to do aquatic sampling with Dr. Te Brugge in Scout Valley, which is a small forest near campus. It's meaningful for me to be able to analyze our environment from a scientific view, and it was a memorable experience studying with my friends and working under my professor's wings. I'm looking forward to going to Algonquin Park for a two-week field school next. I've never been there, so I'm excited!"



**Catalina Amaya  
Bogotá, Colombia**

*Honours Bachelor of Environmental  
Management Graduate*  
**Project Coordinator at Golder Associates,  
Calgary**

"Lakehead and Thunder Bay helped me discover who I was going to become. The faculty were supportive and passionate about what they were teaching. They gave us perspectives outside of the topics covered in class. My professors helped review my resumé when I was completing my studies, and for a few years after graduating, the Faculty would send me job opportunities by email. In my program I studied plant identification, habitats, data collection, statistics, environmental law — this was very useful in the bigger scheme of things, and I applied these skills in the field positions I had before becoming a Project Coordinator."





# CHOOSE CANADA

TOP 10 MOST PEACEFUL COUNTRIES IN THE WORLD\*



ONTARIO

THUNDER BAY



90 MIN

ORILLIA

BARRIE

TORONTO

90 MIN

OTTAWA



EduCanada®  
A world of possibilities  
Un monde de possibilités

## WE ACKNOWLEDGE

Lakehead University respectfully acknowledges its campuses are located on the traditional lands of Indigenous peoples. Lakehead Thunder Bay is located on the traditional lands of the Fort William First Nation, Signatory to the Robinson Superior Treaty of 1850. Lakehead Orillia is located on the traditional territory of the Anishinaabeg. The Anishinaabeg include the Ojibwe, Odawa, and Pottawatomi nations, collectively known as the Three Fires Confederacy.

Lakehead University acknowledges the history that many nations hold in the areas around our campuses, and is committed to a relationship with First Nations, Métis, and Inuit peoples based on the principles of mutual trust, respect, reciprocity, and collaboration in the spirit of reconciliation.



## EMBRACING MULTICULTURALISM

Canada was the first country in the world to adopt multiculturalism as an official policy



## TOP 10 HAPPIEST Countries in the World\*



640,000+ International students studying in Canada



Canadian university degrees  
**RECOGNIZED WORLD WIDE**

## WORK PERMIT

Full-time international students studying in post-secondary programs are eligible to work in Canada while studying.

## AFTER GRADUATION

International students are eligible to apply to stay in Canada and work as part of the post-graduate work permit program for up to 3 years after graduation.

## PERMANENT RESIDENCY

Receive extra points for your Canadian degree when applying for permanent residency.



**THUNDER BAY**

PAGE 8

✈️ 90 MINUTES TO TORONTO



Photo courtesy of Andrea Hamlin

**ORILLIA**

PAGE 12

🚗 90 MINUTES TO TORONTO



**BARRIE**

PAGE 48

🚗 60 MINUTES TO TORONTO



# LAKEHEAD IN THUNDER BAY

Situated in the heart of Canada on the northwest shore of Lake Superior – the world's largest freshwater lake – Thunder Bay is a culturally-diverse city known for its breathtaking natural environment and unparalleled access to outdoor recreation.

Thunder Bay is the epicentre of Northwestern Ontario, offering amenities that attract the whole region, boasting a dynamic entertainment scene, vibrant arts and culture, as well as a variety of locally-owned boutiques, artisan and craft stores, and well-known retail outlets.

🔗 **LEARN ABOUT YOUR NEW HOME!** [lakeheadu.ca/ourhometowns](http://lakeheadu.ca/ourhometowns)

HOME TO THE  
**SLEEPING GIANT**  
ONE OF CANADA'S  
7 WONDERS

1

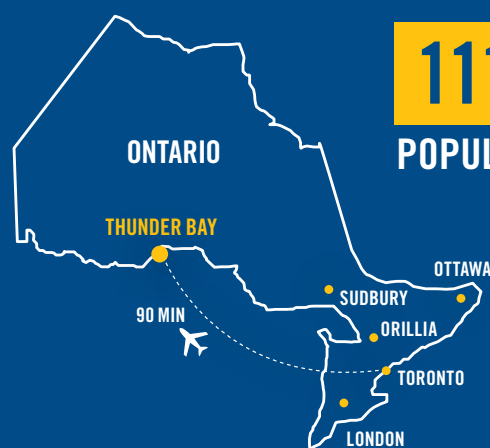

**111,000**  
POPULATION

**7** SHOPPING  
DISTRICTS

**3 MAJOR AIRLINES**  
AIR CANADA, WESTJET  
AND PORTER

**100+** PARKS AND  
RECREATION AREAS

**20+** ANNUAL  
CITY FESTIVALS



**180+ RESTAURANTS** WITH FOOD FROM  
**AROUND THE WORLD**



[VISITTHUNDERBAY.COM](http://VISITTHUNDERBAY.COM)  
[VISITNORTHWESTONTARIO.COM](http://VISITNORTHWESTONTARIO.COM)

📖 **Photo Captions**

1. Thunder Bay Waterfront
2. Thunder Bay's Festival of India & World Dance Collective
3. Students studying at St. Paul Roastery

## THE BEST OF BOTH NATURE AND BIG-CITY AMENITIES



From Thunder Bay, you can explore Ontario's north, its scenic highways, extensive canoe and paddling routes, community festivals, dogsledding or snowmobiling opportunities, the wondrous northern lights, and stunning provincial and national parks.

### THINGS TO DO IN THUNDER BAY

- ▶ Hike, camp and canoe at one of Canada's 7 Wonders: The Sleeping Giant
- ▶ Walk across the Eagle Canyon suspension footbridge, the longest in Canada
- ▶ Take a Latin dancing class or listen to Fort William First Nation's hand drumming at Culture Days
- ▶ Take part in the City's 20+ celebrations: Festival of India, Festa Italiana, Folklore Festival, Holi and Gaura Purnima, Eid at the Thunder Bay Masjid, Chinese New Year, Buskers' Festival, Blues Festival, Parade of Lights, and many more
- ▶ Enjoy a live theatre performance at Magnus Theatre, Cambrian Players, or Paramount Live
- ▶ Listen to the Thunder Bay Symphony Orchestra in our world-class 1,500-seat Thunder Bay Community Auditorium
- ▶ Take in an exhibition at the Thunder Bay Art Gallery or attend one of Definitely Superior Art Gallery's hugely popular Urban Infill events where art and performance take over the downtown core
- ▶ Go back in time at Fort William Historical Park
- ▶ Discover one of the many North American live bands that perform in Thunder Bay pubs



3

### SHOP

**Handcrafts:** Fireweed Crafts, Baggage Building Arts Centre, Finnport, Amethyst Gift Centre, Authentic Gift Centre, Thunder Bay Country Market, Northern Lights Gallery, and more...

**Local Boutiques:** The Loop, MARS, Ungalli, Blush Boutique, Wojo's Mojo, The Finnish Bookstore, Portobello & Hygge Loft, Hill City Comics, Mystic Garden, Street Legal, and more...

**International Retail Outlets:** Sephora, The Body Shop, Starbucks, RW&Co, Roots, Walmart, Bath & Body Works, American Eagle, Urban Planet, Garage, and more...

### EAT

Thunder Bay is a city of restaurants and the perfect place to explore palates from around the world. Student favourites include: Thai Kitchen, The Nook, Monsoon, Madhouse, Royal Aleppo Food, Calico Coffee House, The Sovereign Room, Tokyo House, In Common, and more...

### FROM HERE TO THERE

**THUNDER BAY TRANSIT PASS** is included in your Undergraduate Student Card. City Transit is a safe and convenient way to explore the City of Thunder Bay.

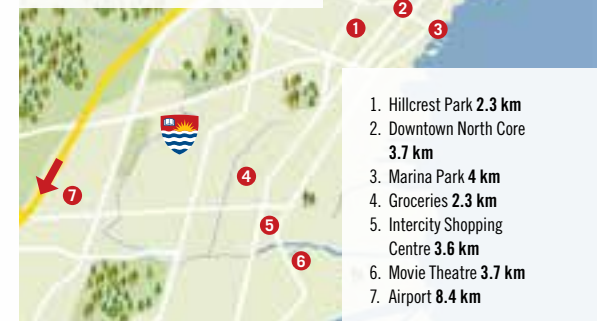

2

Photo courtesy of Incompass Photography



**WINTER**  
(December to February)

Average Daily High: -7°C  
Average Precipitation: 32.43 mm per month

**SPRING**  
(March to May)

Average Daily High: 8.2°C  
Average Precipitation: 52.43 mm per month

**SUMMER**  
(June to August)

Average Daily High: 22.6°C  
Average Precipitation: 84.13 mm per month

**AUTUMN**  
(September to November)

Average Daily High: 10°C  
Average Precipitation: 65.57 mm per month



# LAKEHEAD THUNDER BAY CAMPUS

Located in the centre of the city, the Thunder Bay campus is only minutes away from shopping, restaurants, entertainment, and recreation.

With Lake Tamblin and the McIntyre River as its centrepiece, the Thunder Bay campus has everything to make your university experience complete: seminar-style classrooms, larger lecture halls, cutting-edge laboratories, libraries, computer labs, student services offices, recreational facilities, residences, cafeterias and cafés, and a new International Centre and Lounge right in the centre of campus. Paved trails weaving through campus make it the perfect place to take in the beauty of the area as you unwind by hiking, jogging, skateboarding, bike riding, or cross-country skiing.



## OUR CAMPUS FACTS

### 1 LAKE + RIVER RUNNING THROUGH CAMPUS

# 7,000

STUDENTS

## 15:1

STUDENT TO FACULTY RATIO



#### Photo Captions

1. The Hangar
2. Advanced Technology & Academic Centre (ATAC)
3. Lake Tamblin in the Winter
4. A view of campus from the Centennial Courtyard
5. Centre for Advanced Studies in Engineering & Sciences (CASES)
6. Bartley Residence Single Dorm Room
7. Main cafeteria

## THUNDER BAY CAMPUS RESIDENCE

### YOUR HOME AWAY FROM HOME

Lakehead University Residence is a fun, safe and convenient place to live. Our Residence Life Team is dedicated to organizing events, activities and excursions, allowing you to get involved in campus life, become friends with students from other countries and programs, and explore the city. Take advantage of the supports and 24-hour security Residence offers.

[lakeheadu.ca/residence](https://lakeheadu.ca/residence)

**Single Dorm Room:** 18 m<sup>2</sup>  
\$12,156.00 CAD for 8 months\*  
including meals

- ▶ WiFi, mini-fridge
- ▶ Shared laundry, washrooms and lounge
- ▶ Mandatory meal plan (7 days a week, all you can eat)

**Townhouse:** 93 m<sup>2</sup>  
\$7,873.00 CAD for 8 months\*

- ▶ 4 private bedrooms per townhouse
- ▶ Shared living room
- ▶ 1 washroom
- ▶ Full kitchen
- ▶ WiFi

**Apartment:** 77 m<sup>2</sup>  
\$7,462.00 CAD for 8 months\*

- ▶ 4 private bedrooms per apartment
- ▶ Shared living room
- ▶ 2 washrooms
- ▶ Full kitchen
- ▶ WiFi



\* Prices are for the 2020-2021 academic year

### 1000+ STUDENTS LIVING IN RESIDENCE

### MEAL PLANS

Lakehead University offers many options for dining on campus, so that you can enjoy meals and snacks that are both nutritious and convenient. Choose from vegetarian, vegan, halal, gluten free, and Asian food options.

Students in our dormitory-style residence halls automatically receive a full meal plan that includes all day dining in the Residence Cafeteria (unlimited access during hours of operation) + \$800.00 CAD declining balance (like a debit card that can be used anywhere on campus where the food service is operated by Aramark.)

### FOOD OUTLETS ON CAMPUS

**Residence Cafeteria** - All-you-care-to-eat nutritious home-cooked entrées, fresh salad bar, soups, ready-made sandwiches, fruit, pizza, pitas & wraps, baked goods, freshly-made fries, grilled meals, Asian food, beverages, and more.

**Main Cafeteria** - Food Court style setting serving grilled burgers, Bento sushi, ready-to-serve sandwiches and salads, Pizza Pizza, soups, snacks.

**Dan's Diner** - Late night snacks: submarine sandwiches, salads, gourmet hotdogs, desserts, and smoothies.

**Subway** - Soups, sandwiches, snacks.

**Library Café** - Coffee, lattes, espresso and cappuccino beverages, ready-to-go sandwiches, pastries, and salads.

**The Outpost** - A hearty menu of mealtime favorites.

**The Study** - A variety of hot and cold beverages, delicious baked goods, and savoury snacks.

**Starbucks** - Hand-crafted coffee, tea, espresso, cappuccino, latte, breakfast baked goods, sandwiches and snacks. A full-service outlet.

**Persian Man & Rose N Crantz Roasting Co.** - A variety of baked goods and locally-roasted gourmet coffee.

[lakeheadu.ca/mealplans-thunderbay](https://lakeheadu.ca/mealplans-thunderbay)





# LAKEHEAD IN ORILLIA

The City of Orillia is home to Lakehead University's newest campus and is located near the Greater Toronto Area (GTA) in the heart of Ontario's Lake Country on the shores of Lakes Couchiching and Simcoe.

With year-round opportunities for recreation, culture and heritage, Orillia has all the amenities of a large urban centre with small-town charm. Enjoy the beautiful open spaces and waterfront parks around the city as well as the specialty shops, cafés, restaurants, movie theatres, and locally-owned boutiques.

🔗 **LEARN ABOUT YOUR NEW HOME!** [lakeheadu.ca/ourhometowns](http://lakeheadu.ca/ourhometowns)



Photo: Loop Media



**31,000**  
POPULATION



**100+** RESTAURANTS

**90** MINUTE DRIVE  
FROM TORONTO



GATEWAY TO  
LAKE COUNTRY

**200+ KM** OF MOUNTAIN  
BIKE TRAILS

**30+** ANNUAL  
FESTIVALS

**ORILLIA.CA**  
**ORILLIALAKECOUNTRY.CA**

📖 **Photo Captions**

1. Orillia Waterfront
2. Phat biking in winter
3. Shopping in downtown Orillia

## ENJOY SMALL-TOWN FRIENDLINESS AND BIG-CITY FUN RIGHT ON YOUR DOORSTEP

### THINGS TO DO IN ORILLIA

- ▶ Stroll along the downtown Orillia boardwalk on Lake Couchiching, or spend your day at Couchiching Beach Park
- ▶ Hang out and indulge in the treats downtown at Mariposa Market
- ▶ Explore the hiking trails at Scout Valley
- ▶ Catch a live band at the Brownstone or at the Roots North Music Festival
- ▶ Join in one of the many city festivals: Mariposa Folk Festival, Streets Alive, Culture Days, Orillia Jazz Festival
- ▶ Get to know the region through art and history at the Orillia Museum of Art History or the Stephen Leacock Museum
- ▶ Go ice skating in the winter at one of the many outdoor ice rinks
- ▶ Join a group of friends for roller skating at the 1,400m<sup>2</sup>+ Roller Skating Place in Orillia
- ▶ Experience the beauty of the Horseshoe Valley with the unparalleled thrill of riding a Segway



Photo courtesy of Andrea Hamlin



### SHOP IN ORILLIA

**Local Boutiques:** Fashion Therapy, Refillery District, Manticore Books, Alleycats Music & Art, Mac Jac, Candles with Care, Dr. Comics, Gilbert Guitars, Barn to be Wild, Studio Eleven, and more...

**Retail Outlets:** Alia N Tan Jay, Ardene, Coles, Costco, Eclipse, Homesense, Maurices, Reitmans, Staples, Best Buy, Value Village, Winners, Walmart, and more...

### EAT IN ORILLIA

Orillia offers a wide range of restaurants for every appetite.

**Student favourites include:** Booster Juice, Breakfast Club, Theo's Eatery, Viet & Thai Restaurant, Aladdin, Brewery Bay, Yo Taco, Apple Annie's, Kenzington Burger Bar, Mariposa Market, Mucho Burrito, Royal Oak Restaurant, Rustica Pizza Vino, Sanafir, Starbucks, Shine Juice Bar and Café, Sushi Wadasi, Thai Plate, and more...

### FROM HERE TO THERE

**ORILLIA TRANSIT PASS** included in your Undergraduate Student Card. Take advantage of this safe and convenient way of exploring Orillia.



1. Westridge Place (Groceries, Banks, Shopping, Movies) 2.3 km
2. Orillia Bus Terminal 4.5 km
3. Couchiching Beach 6 km
4. Ontario Northland Bus Station (for out-of-town buses) 4.8 km
5. Downtown Restaurants, Pubs & Cafés 4.5 km
6. YMCA Gym 5.7 km
7. Tudhope Park 6.7 km



**Experience All  
Four Seasons!**

#### ❄️ WINTER

(December to February)

Average Daily High: -0.3°C  
Average Precipitation:  
84.4 mm per month

#### 🌱 SPRING

(March to May)

Average Daily High: 10.7°C  
Average Precipitation:  
110.33 mm per month

#### ☀️ SUMMER

(June to August)

Average Daily High: 26.7°C  
Average Precipitation:  
97.0 mm per month

#### 🍂 AUTUMN

(September to November)

Average Daily High: 14.7°C  
Average Precipitation:  
64.5 mm per month



# LAKEHEAD ORILLIA CAMPUS

Known for its welcoming atmosphere, innovative programs, and friendly community, the Orillia campus is one of the best places to grow as a student.

The Orillia campus offers the complete university experience with the Simcoe Hall academic building, cutting-edge laboratories, a vibrant Learning Commons, classrooms filled with natural light, residence, bookstore, and open-style cafeteria. As part of a young and growing campus, you will play an important role in shaping student life.



## ORILLIA CAMPUS RESIDENCE

### YOUR HOME AWAY FROM HOME

There's no better way to get the full university experience than to live in residence. With cafeteria, classes, and campus amenities just steps away, you will enjoy the convenience of living on campus.

Our Residence Life Team is there for you 24 hours a day, 7 days a week, and is dedicated to offering you support and organizing exciting events for you and all members of your new residence family.

[lakeheadu.ca/residence](https://lakeheadu.ca/residence)

**Single Dorm Room:** 16.5 m<sup>2</sup>  
\$12,734.00 - \$13,334.00 CAD  
for 8 months\* including meals

- ▶ WiFi, mini-fridge
- ▶ Social lounge, study rooms, laundry facilities
- ▶ In-suite sink, adjoining bathroom shared with one other room
- ▶ Mandatory meal plan

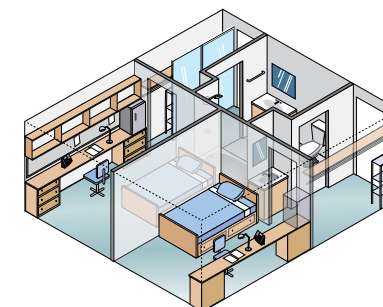

\* Prices are for the 2020-2021 academic year

### MEAL PLANS

Included with the residence accommodation package at the Orillia Campus is a declining balance dollars meal plan that you are automatically enrolled in. Our Main Cafeteria as well as the Kiosk in the Academic Building offer vegetarian, vegan, halal, and gluten-free options. There are two meal plan options to choose from:

**Plan A - \$4,400.00 CAD\*** - For students not on campus on weekends and those with lighter appetites.

**Plan B - \$5,000.00 CAD\*** - For students on campus most weekends and those with larger appetites.

[lakeheadu.ca/mealplans-orillia](https://lakeheadu.ca/mealplans-orillia)

\* These amounts are included in the residence price listed above.

### OUR CAMPUS FACTS



**ENVIRONMENTALLY  
DESIGNED AND CERTIFIED  
CAMPUS (LEED)**

**1,500 STUDENTS**

**13:1 STUDENT TO FACULTY RATIO**



**DISCOUNTED AND DEDICATED  
BUS SERVICE DAILY  
FROM THE CITY OF BARRIE TO  
ORILLIA CAMPUS**

#### Photo Captions

1. The Learning Commons is the hub of campus where you can go to study, meet friends, or attend a special event.
2. Science Lab
3. Lecture Theatre
4. Simcoe Hall
5. Orillia Campus Residence
6. Residence Lounge
7. Residence Room
8. Students soak up the sun outside the Dining Hall



**1000+ STUDENTS  
LIVING IN RESIDENCE**



# THE STUDENT EXPERIENCE

Lakehead offers you much more than just a world-class education. We make it easy for you to get involved in clubs and recreation, to access a range of student supports, to deepen your learning through internships and co-operative education, and to help pay for university through our generous scholarship program. Discover the inside story on the student experience through two Lakehead students, Leanne and Ritwik.

## A WEEK IN THE LIFE OF LEANNE

Business Student, Orillia Campus  
From Taipei, Republic of China (Taiwan)

### MONDAY

I have one of my favourite classes today, Business Communications, with one of my favourite professors. During presentations in this class, he really encourages me to step out of my comfort zone. Lakehead has changed me from being in a participant position to a leadership position.



Last fall I won a Simcoe County Youth Community Champion Award.

### TUESDAY

This morning I'm reviewing notes for a test in my Strategic Management Theory class in my usual spot, the study room next to the library, which I booked online. After that, I'm using my university pass at the YMCA to go for a swim!



### WEDNESDAY

After class I go straight to the Community Development Corp where I am working 6 hours a week for my RBC Work-Integrated Learning placement. I get to see how academics and the real business world connect.



### THURSDAY

I'm a Peer Mentor this semester to a group of new students from India, China and Vietnam, and I want to introduce them to one of my favourite cafés in downtown Orillia, Mariposa Market.



### FRIDAY

I'm a member of LUMA, the Lakehead University Multicultural Association. Today we're meeting to start planning for the Lunar New Year celebration on campus. I like that I can celebrate my culture at school through LUMA.

### SATURDAY

This afternoon, I'm going to cook! The International office is having a potluck party tonight, and I'm making ribs.

### SUNDAY

In addition to doing homework, I usually call my family on the weekend, and that's what I'm doing today. It's easy through WeChat to connect any time.



## A WEEK IN THE LIFE OF RITWIK

Psychology Student, Thunder Bay Campus  
From Ahmedabad, India

### MONDAY

In Psychology class today, Dr. Moland (who actually prefers to be called "Mike") brought an electric piano to class. He played it while talking to the class to demonstrate how procedural memory works.

### TUESDAY

This semester, I'm taking 5 classes and 3 labs, which is about 15 hours of classes and 10.5 hours of labs a week. Tuesdays is a busy day, but in between classes, I have time to do homework in one of my favourite campus study spots in the Centennial Building.



### WEDNESDAY

This afternoon I'm in the lab with Dr. Tan where I am a volunteer research assistant for a project on the Nunavut Crisis Helpline. My interactions with Dr. Tan have been really wonderful. Every time she talks about anything related to Psychology I am taking mental notes to learn from her as much as I can.



### THURSDAY

My classes end early on Thursdays, so I went cycling with friends to the Cascades, a popular spot along the Current River.

### FRIDAY

Tonight, my friends and I are making our costumes for the Halloween party happening in downtown Thunder Bay at the end of the month. We don't really celebrate Halloween in India, so I am excited to go to my second-ever Halloween. But I also like introducing others to my culture, like the recent Bollywood Night.



### SATURDAY

Saturday morning is Res Sports on campus, organized by our Residence Life Coordinator. We compete against others in Residence in all kinds of sports.

### SUNDAY

Some people may not think of Stats as a particularly fun class, but I have a fun prof. Today I'm working on my weekly assignment, always due Sundays. As he says, he likes to "train the Math muscles in our brain."



# STUDENT CLUBS & LEADERSHIP



1

Play a bigger part in a smaller student body at Lakehead University where your engagement in the community nurtures your development as a citizen of the world. Enrich your university years through involvement in academic or cultural clubs, volunteering, or leadership development opportunities.



2



3



4

## STUDENT-RUN FESTIVALS AND EVENTS

Whether you're representing your country in Culture Days on campus, planning a Chinese New Year Celebration, taking part in the city's Holi Festival, or helping newcomers to Canada at the city's Multicultural Centre, you will find the whole university community gets involved when they celebrate holidays, festivals and special occasions.

## LEADERSHIP OPPORTUNITIES

Develop new skills and grow as a person while getting involved in group activities and meaningful projects through the EXCEL Leadership program or by becoming a Global Ambassador or Peer Mentor to new international students.

## LAKEHEAD UNIVERSITY STUDENT UNION (LUSU)

LUSU is run for students, by students. Add your voice to student government or get involved in one of the LUSU Centres such as the Aboriginal Awareness Centre, Multicultural Centre, Pride Central, or the Sustainability Initiative.

## STUDENT CLUBS

Clubs are the cornerstone of student life at Lakehead. Whether you're interested in sports, movies, video games, politics, or academics, Lakehead University has a club for you. Here is a sample of the 60+ clubs available for you to join:

- ▶ African Caribbean Student Association
- ▶ Lakehead University Badminton Club
- ▶ Lakehead Iranian Cultural Association
- ▶ Korean Student Association of Lakehead University
- ▶ Lakehead Engineers Without Borders
- ▶ Lakehead Martial Arts
- ▶ Lakehead University Anime & Manga
- ▶ Lakehead University Indian Students Association
- ▶ Muslim Student Association
- ▶ Chinese Students and Scholars Association
- ▶ Southeast Asia Society
- ▶ And many more....You can even start your own unique club!

## A LITTLE PIECE OF HOME IN CANADA



“ Celebrating my culture with the African Caribbean Student Association (AFCASA) brings me closer to home. I know that there are other people like me and we can go through experiences together as a family. One of my fondest memories with AFCASA to date has been (and I think will always remain) celebrating Black History Month. But I also can't forget the night we all went out as a group to see the Black Panther movie: “WAKANDA FOREVER!” Clubs are a lovely way to meet people and share moments and experiences, and AFCASA never dulls out.”

**Bright Onogwu**  
Nigeria  
Chemistry Student



### Photo Captions

1+2. Student Union Culture Days

3. Chinese Students & Scholars Association promotes an upcoming event

4. Engineering Student Society “Bus Pull” Fundraiser





# GLOBAL AMBASSADORS

**The Global Ambassador Program is the ultimate opportunity for you to enrich your student experience on campus, develop your leadership skills, and share your Lakehead pride with future students.**

The Global Ambassador Program brings together Lakehead's most enthusiastic, globally-minded, inclusive and inquisitive students, and acts as a stage for collaboration, knowledge creation and exchange among Lakehead's diverse student body.

As a Global Ambassador, you will express the proud voice and spirit of Lakehead to future students and alumni around the world. You may also have the opportunity to advance and become a leader within the Program. Together with the team of Global Ambassadors you will participate in activities like:

- ▶ Representing current students and connecting with future students in your home country
- ▶ Attending and supporting on-campus events
- ▶ Volunteering with community organizations
- ▶ Engaging and encouraging students to participate in activities and events
- ▶ Supporting the planning and development of future events

🔗 [lakeheadu.ca/global-ambassadors](http://lakeheadu.ca/global-ambassadors)



## MAKING WORLDWIDE CONNECTIONS AT LAKEHEAD

“ I am a person who wants to get to know and connect with people from diverse nations and cultures. Every new connection and communication with different cultures increases human social life and capacity. At the first Global Ambassador workshop I attended, we worked as a team, and I made a lot of friends. I also want to be able to introduce the positive aspects of the university where I study to future students – the benefits of Lakehead's smaller classes and the fantastic nature of Thunder Bay – so that I can help open the way for them to come to Canada.”

**Kiana Farrokhi**  
Tehran, Iran  
Business Management Student



# INTERNATIONAL CENTRE



**Located in the heart of the Thunder Bay campus, the International Centre is the meeting place for students from all over the world.**

## THE HUB OF CAMPUS

This is the place to be! Join us in between classes or in the evening where you can grab a coffee, visit with friends, play Xbox, watch a soccer game, or take part in one of our special events, such as Culture Days. This is also the home of our English Language Centre, where we offer English classes all year round for those who are preparing to enter an academic program, or who simply wish to improve their English.

🔗 [lakeheadu.ca/international-student-support](http://lakeheadu.ca/international-student-support)



### Photo Captions

1. A gathering place between classes and for events
2. Students host culture day event
3. Students teach Latin Dancing
4. The International Lounge
5. A calligraphy demo for students







# ATHLETICS AND RECREATION

## Take a break from your studies – embrace the outdoors, cheer on your Thunderwolves and join the action!

The ultimate stress reliever is at the doorstep of our campuses - the great outdoors. Escape from your studies and enjoy:

- ▶ A scenic hike at the Sea Lion, the Sleeping Giant, Mount McKay, or Scout Valley Trails
- ▶ Snowboarding or skiing at Loch Lomond or Horseshoe Valley
- ▶ Rock or ice climbing to spectacular scenic views with Outdoor Skills and Thrills
- ▶ Winter exploration in snowshoes
- ▶ Canoe or kayak on Lake Simcoe or Lake Superior
- ▶ A boat tour with Sail Superior or Orillia Boat Cruises
- ▶ Mountain biking on rugged and winding forest trails



## VARSITY & CLUB TEAMS:

VARSITY	M	W	CAMPUS
Basketball	•	•	T
Cross-Country Running	•	•	T
Golf	•	•	O
Hockey	•	•	T
Indoor Soccer	•	•	O
Nordic Skiing	•	•	T
Track and Field	•	•	T
Volleyball	•	•	T
Wrestling	•	•	T

CLUB TEAMS	M	W	CAMPUS
Alpine Skiing	•	•	T
Basketball	•	•	O
Cricket	•	•	T
Curling	•	•	T
Equestrian	•	•	O
Hockey	•	•	O
Hockey	•	•	T
Rugby	•	•	T
Soccer	•	•	T
Ultimate Frisbee	•	•	T
Volleyball	•	•	T

**+** Join a RECREATIONAL TEAM like Badminton, Synchronized Swimming, or Flag Football

T Thunder Bay Campus O Orillia Campus

## RECREATIONAL FACILITIES



### THUNDER BAY CAMPUS

Just a short walk from our academic buildings and residence are our on-campus fitness facilities designed to keep our Thunderwolves active.

#### C.J. SANDERS FIELDHOUSE

A 30,000-square-foot facility featuring:

- ▶ Weight rooms
- ▶ Olympic-sized swimming pool
- ▶ Cardio machines
- ▶ Aerobics studio
- ▶ Outdoor sports fields
- ▶ Beach volleyball court
- ▶ Hot yoga studio
- ▶ Changerooms & saunas
- ▶ “Thunderdome” gymnasium

#### THE HANGAR

A 50,000-square-foot facility featuring:

- ▶ Indoor 200-metre track
- ▶ Pro-grade artificial turf field
- ▶ Aerobic and cardio areas
- ▶ Sports Medicine Clinic

#### THE WOLF DEN

This brand-new facility will include:

- ▶ Full-size gym, cardio, weight and aerobics rooms
- ▶ More space for student and community recreational programming
- ▶ Health and wellness services
- ▶ Outdoor basketball courts and fitness equipment
- ▶ Enhanced public and community spaces for large events

[thunderwolves.ca](http://thunderwolves.ca)



### Lakehead University celebrates international student, Leashja Grant from The Bahamas, who took the varsity basketball team to new heights.

Winner of the USports First Team All-Canadian



### ORILLIA CAMPUS

As an Orillia campus student you can join one of the active recreational or club teams, or try out for a competitive varsity sports team. With both indoor and outdoor recreational opportunities in Orillia and the region, you will have the opportunity to balance your studies with physical activity to stay healthy.

[orilliathunderwolves.ca](http://orilliathunderwolves.ca)



### Lakehead University celebrates international student and varsity wrestler Hasan Ercan, Business student from Turkey

Winner of the Men's Wrestling Most Improved Award, Hasan's hard work and commitment led him to a second place finish at the 54kg class at the Ontario University Athletics (OUA) Championships. Hasan was also named OUA Second Team All Star.



#### Photo Captions

1. Lakehead cricket team
2. Equestrian team competes
3. Thunderwolves Women's Basketball team
4. Whiteout (how our fans cheer their varsity teams)
5. Ice skating on Lake Tamblyn

Photo: Superior Images



# SUPPORTING YOU

Lakehead University is committed to helping you at each step of your journey as a university student. Our student-centred philosophy and our personalized supports give you the highest chance for success.

## PEER MENTORING

As a new international student, you can take advantage of our free Peer Mentor Program where we connect you with a senior student, who will help guide you at Lakehead.

[lakeheadu.ca/peermentor](https://lakeheadu.ca/peermentor)

## INTERNATIONAL STUDENT SERVICES

### FREE AIRPORT PICK-UP

We welcome you to the city by arranging transportation from the airport to your residence. Once you accept your Letter of Acceptance, you'll receive a welcome package with information on how to sign up.

### NEW STUDENT ORIENTATION

Learn to navigate through campus, discover the University's support systems, and explore the culture of your new home away from home. Get the answers to any questions you may have relating to the campus, community and culture, and how to get involved and connect with new friends.

## INTERNATIONAL ADVISING

The International Office can help you navigate the university services you may need to access and will provide you with information and guidance on many things including health insurance, city services, and personal matters.

### IMMIGRATION ADVISING

Lakehead University International is pleased to have a Regulated International Student Immigration Advisor (RISIA) certified by ICCRC on staff to assist with your questions and applications for study permits, work permits and travel visas.

### EXCURSIONS

Get to know students from all over the world while you explore your new hometown through fun activities and outings designed especially for you.

[lakeheadu.ca/international-student-support](https://lakeheadu.ca/international-student-support)



**“** In addition to the Academic Support Zone Coordinator assisting me with writing techniques, I received the help of a writing coach for several semesters. This is a free service, and I could easily make appointments online. My writing coach helped review my assignments. He was patient and professional, and he encouraged and inspired me in my academic writing. I learned a lot from him not only about language but also about the unique thoughts on English academic writing by non-native writers.”

**Zheng Ma**  
Kaifeng, China  
Social Justice Education Student



## ACADEMIC SUPPORTS

- ▶ Academic Advising
- ▶ Skills for Success Workshops
- ▶ Tutoring & Peer-Assisted Learning
- ▶ Math Centre
- ▶ Writing Centre
- ▶ Registration Assistance & Course Planning
- ▶ Library
- ▶ Student Accessibility Services

## CAREER PLANNING

- ▶ Career Counselling
- ▶ Resumé Writing & Interview Preparation
- ▶ Skill Development Job Bank
- ▶ Co-operative Education Services
- ▶ Job & Employment Fairs
- ▶ On-Campus Job Opportunities
- ▶ Leadership Development
- ▶ Co-Curricular Record

## HEALTH & WELLNESS

- ▶ Medical Clinic (Thunder Bay)
- ▶ Naturopathic Doctors (Orillia)
- ▶ Personal Support Counselling

## FINANCIAL

- ▶ Financial Planning & Budgeting Support
- ▶ Scholarships, Bursaries & Awards

## MORE SUPPORTS

- ▶ Office of Human Rights & Equity
- ▶ Daycare (Thunder Bay)
- ▶ Off-Campus Housing
- ▶ Food Bank
- ▶ Ombudsperson
- ▶ Security Services
- ▶ Lakehead University Student Union (LUSU)

## FIRST-YEAR EXPERIENCE

- ▶ Orientation
- ▶ Conversation Club
- ▶ Peer Mentor Program
- ▶ Global Ambassador Program

As an international student, you can complete a one- or two-semester study abroad exchange at one of Lakehead's many partner universities. Get credit toward your degree and further enhance your cultural intelligence.

## GIVING BACK TO NEW STUDENTS

**“** I was inspired to become a Peer Mentor because I wanted to be a role model to new students and to help them feel less lonely. When you first arrive, you may experience homesickness, and my goal was to be friendly, approachable, and to help guide students to university resources as they adjusted to academic life.

Together with my group of mentees, we got out and experienced the city, and I showed them my favourite places — the waterfront and Hillcrest Park. We took a group trip to Kakabeka Falls and we also did some really “Canadian” activities: air hockey and dragon boat racing on ice. (Our team won the dragon boat race!)

These were amazing experiences of bonding and new friendships. Not only that, I developed beneficial leadership and interpersonal skills.”

**Vatan Singh Nayal**  
Hyderabad, India  
Computer Science Student





1

# ENRICHING YOUR EDUCATION

Having hands-on experience related to your field of study before you even graduate gives you a competitive advantage as you enter into your career. Lakehead University integrates practical components—such as internships, field school and community engagement—into its programs whenever possible.

## TOP 2 IN ONTARIO FOR EXPERIENTIAL LEARNING

(Maclean's University Rankings 2020)

### 100% OF STUDENTS

TOOK PART IN EXPERIENTIAL  
LEARNING IN 2019/20



2



## COMMUNITY ENGAGEMENT

Community service learning provides you the opportunity to link your studies with our local communities. Many of our courses allow you to contribute towards helping address critical social issues in our neighbourhoods.



## INTERSHIPS

Many of our programs include internship or field school opportunities. Translate the concepts and principles learned in class into practical skills in the workplace. Research internships are great opportunities to enhance your field of study and can often lead to summer or even full-time employment.



## PRACTICUMS, PLACEMENTS AND FIELD EXPERIENCES

Many of our programs have integrated practicums and placements, or the opportunity for field schools and trips. These experiences can range from six-week clinical placement courses in Nursing or field practice experiences with human service agencies in Social Work, to exploring the ecosystem of a natural, environmentally-protected bog in Environmental Sciences.



## RESEARCH

Every day, we are inspiring and creating leaders. At most universities, the opportunity to get involved in research is unlikely during your undergraduate years. At Lakehead, we encourage our students to seek out research opportunities beginning in their undergraduate programs. Our extensive Research & Innovation Week activities, Undergraduate Research Day and research publications allow students and faculty alike to showcase the work they are doing.

🔗 [lakeheadu.ca/research](https://lakeheadu.ca/research)

- ▶ 26% of undergraduate students are engaged with faculty in research
- ▶ Read about student research projects in science in Quaestiones Naturales: [lakeheadu.ca/qnmagazine](https://lakeheadu.ca/qnmagazine)

## #1 UNDERGRADUATE RESEARCH UNIVERSITY IN CANADA

(RESEARCH Infosource, 2015-2019)

### Photo Captions

1. CASES Advanced Wastewater Biohazard Lab
2. Lakehead University's Natural Resources Management Field School visited the San Felipe Bacalar Tropical Forest Research Centre (INIFAP) in Mexico
3. Green Processes Research Centre



## UNDERGRADUATE STUDENT RECEIVES FUNDING FOR COVID-19 RESEARCH

“ I was aware of Lakehead's status as Canada's #1 Undergraduate Research University. As an undergraduate student, not only was I able to be a research assistant at the Summer School of Medical Imaging in the Thunder Bay Regional Research Institute, I was a co-author on an article with my professor and a PhD student to outline our findings.

There is a lot of support in Canada and at Lakehead to fund undergraduate research. Lakehead has a solid research department and a lot of professors who have availability and are willing to take on new students.

This summer I received a MITACS Research Award that my professor, Dr. Floriano, helped me apply for. The stipend will fund my research project relating to COVID-19 (medical name: SARS-CoV-2). I will be predicting the most likely mutants of SARS-CoV-2 at the main protease level to determine which therapeutic options against the mutants will be most effective. I can do the research from home and report to Dr. Floriano remotely.

It was very exciting for me. I have been affected as much as anyone by the COVID-19 pandemic, but as an aspiring scientist, I thought it would be interesting to research it when it's most relevant and to feel that my work is impactful. To have the opportunity this early in my career excites me.

Lakehead University has helped me achieve my goal of completing at least one full research project from beginning to end. Every step of the process is a learning experience. I now know what it takes from zero to 100, and I can do it again and get better.”

**Alejandro Ortigas-Vásquez**

Peru

Bioinformatics Student

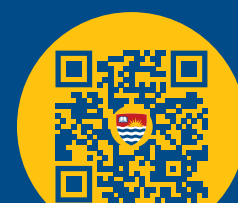





LAKEHEAD STUDENTS  
ARE TOP 3 IN  
ONTARIO  
FOR JOB READINESS

# CO-OPERATIVE EDUCATION

Alternate your academic studies with periods of work where you will deepen your knowledge of your field while you earn additional money and build your resumé for the future.

## A HEAD START ON YOUR CAREER

- ▶ Full-time, paid work experience in your field for 4-16 months
- ▶ Earn \$14 - \$30 CAD per hour
- ▶ Lakehead has partnered with over 140 national and international companies including: RBC, Blackberry, Union Gas, Bosch, IBM, Hydro One, Suncor, Husky, AECON, Grant Thornton, Goldcorp, Bombardier, Ministry of Education, Canada Revenue Agency, Honda, and more.

🔗 [lakeheadu.ca/coop](https://lakeheadu.ca/coop)

## PROGRAMS THAT OFFER CO-OP

At Lakehead University, there are a variety of disciplines that offer the co-op option:

- ▶ Honours Bachelor of Commerce: Accounting, Finance, Human Resources Management/Industrial Relations, Information Systems, Marketing T
- ▶ Honours Bachelor of Commerce: Business Administration, Global Entrepreneurship O
- ▶ Computer Science (Honours Bachelor & Masters Programs) T
- ▶ Computer Science (Diploma + Degree) LG
- ▶ Economics (Masters Programs) T
- ▶ Engineering: Chemical (Bachelor); Civil (Bachelor & Masters); Electrical (Bachelor); Mechanical (Bachelor & Masters); Software (Bachelor); Electrical & Computer (Masters); Environmental (Masters); Bachelor of Engineering + MBA T
- ▶ Engineering: Electrical (diploma+degree) LG
- ▶ Environmental Management (Honours Bachelor) T
- ▶ Environmental Sustainability (Honours Bachelor) O
- ▶ Forestry (Honours Bachelor) T
- ▶ Kinesiology (Honours Bachelor) T
- ▶ Mathematical Sciences (Honours Bachelor & Masters Programs) T
- ▶ Physics (Honours Bachelor & Masters Programs) T

T Thunder Bay Campus O Orillia Campus LG Lakehead-Georgian



“It was important for me to get formal Canadian work experience through co-op to help with my prospects after graduating. The Student Success Centre really helped me through the process to develop my CV and prepare for the interviews. One of my professors provided me with a great reference. I got a position in Enterprise Technical Support at Blackberry, which allowed me to learn the current industry standards and to work with diverse people across many different time zones.”

**Tomisin Olasimoju**  
Nigeria  
Computer Science, Co-op Placement at Blackberry



# EMPLOYMENT

## CAREER ZONE

Devoted to your success after graduation, our Student Success Centre's Career Zone hosts four annual career fairs in which you can network with prospective employers right on campus to explore future careers. The Career Zone also offers you a wide range of services including resumé and interview preparation workshops, one-on-one career advising, an online job bank, career exploration resources, and, in collaboration with Lakehead University International, dedicated advisors for international students.

🔗 [lakeheadu.ca/careerzone](https://lakeheadu.ca/careerzone)

## ON- AND OFF-CAMPUS JOBS

As a full-time international student, you are eligible to work up to 20 hours per week during the academic school year and up to 40 hours per week in the summer or during regular study breaks in your program. Not only can you earn money to put toward your studies, you will also gain valuable Canadian work experience that will enhance your resumé. Students have access to the Lakehead University job bank and career services.

🔗 [lakeheadu.ca/careerzone](https://lakeheadu.ca/careerzone)



96.7%

EMPLOYED 2 YEARS AFTER GRADUATION  
(HIGHER THAN THE ONTARIO AVERAGE)



## WORKING TO BUILD MY SKILL SET

“Working part-time while pursuing my degree helped me to offset my living expenses such as rent and food. Canada is a land of opportunities, and I found a position as a Guest Services representative at the biggest mall in Thunder Bay - Intercity Shopping Centre. This experience truly helped me build my customer service and interpersonal skills. I have seen myself grow into a more compassionate and a confident woman over the past two years because I had to interact with people of all ages and backgrounds in this job. Working in a fast-paced environment with different teams has also greatly improved my collaborative and organizational skills.”

**Catherine Rachel Samuel Rajkumar**  
India  
Master of Computer Science Graduate



📖 Photo Captions

1. A student gets help from her professor in the Advanced Wastewater Biohazard Lab 2. Students speak to a potential employer at a Career Fair on campus



# SCHOLARSHIPS

**TOP 2 IN ONTARIO  
FOR STUDENT AWARDS**  
(Maclean's University Rankings 2020)

Take advantage of one of Canada's most generous university scholarship programs. We make paying for your university degree easier so you can focus on your education.

## RENEWABLE UNDERGRADUATE ENTRANCE SCHOLARSHIPS

**Automatically awarded. No application required.**

Non-Canadian citizens who are entering Lakehead University from a high school, or who are transferring from an international college or university, will be considered for the Undergraduate Entrance Scholarships. The scholarship is available to the top international students applying to Lakehead University for 2021-2022.

[lakeheadu.ca/entrance-scholarships-international](https://lakeheadu.ca/entrance-scholarships-international)

Academic Average (Canadian Equivalent)	IB Average	Scholarship Total <sup>1</sup> (Value Per Year)
<b>90.0% &amp; OVER</b>	<b>35+</b>	<b>= \$40,000 CAD</b> (\$10,000 x 4 years) <sup>1</sup>
<b>80.0% - 89.9%</b>	<b>30-34</b>	<b>= \$30,000 CAD</b> (\$7,500 x 4 years) <sup>2</sup>
<b>75.0% - 79.9%</b>	<b>28-29</b>	<b>= \$6,000 CAD</b> (\$6,000 in Year 1 only) <sup>3</sup>

<sup>1</sup> Renewable provided a 90% average is achieved in each academic year. If a student's university academic average falls between 80.0% - 89.9%, the student will receive an amended scholarship valued at \$7,500 CAD/year for each subsequent academic year for the remaining term of the scholarship.

<sup>2</sup> Renewable provided an 80% average is achieved in each academic year.

<sup>3</sup> Non-renewable, one-time only scholarship awarded in Year 1.

<sup>4</sup> Maximum length of scholarship term is 4 academic years or until the first degree is awarded, whichever occurs first. Recipients whose status changes and may be charged domestic fees will have their scholarship value reassessed to equate to the domestic entrance scholarship grid and regulations available at that time.

## GRADUATE ASSISTANTSHIPS

Graduate Assistant appointments may be offered to some full-time graduate students (including Visa students) at a rate of \$10,197.68 CAD at the Master's level and \$11,120.82 CAD at the Doctoral level (2019-20 rates\*). A regular appointment constitutes a maximum of 270 hrs of work over the Fall and Winter terms, averaging not more than 10 hours of work per week.

\*2020-21 rates are announced in Fall 2020.

## FACULTY RESEARCH AWARDS FOR GRADUATE STUDENTS

A stipend may be paid to a full-time degree candidate for research or academic activities relevant and related to the student's field(s) of study within the academic program. Faculty Research Awards are awarded by the student's supervisor.

[lakeheadu.ca/graduate-funding](https://lakeheadu.ca/graduate-funding)

**\$2,445,500 CAD**  
AWARDED TO INTERNATIONAL  
UNDERGRADUATE STUDENTS ANNUALLY



**“ I was won over by the Business program, but the entrance scholarship did play a role in my decision to choose Lakehead.**

I felt proud of my grades and of the hard work I had put in to achieve them. My scholarship is renewable every year and it works as a great motivator for me to excel in my academics year after year.”

**Vishwa Shah**

India  
Business Student



# BUDGETING FOR UNIVERSITY

Going to university will be one of the biggest and most important investments you will ever make. Below is a chart to help you understand the costs involved and prepare a budget.

		Undergraduate: for one academic year (2 semesters/8 months)	Graduate: for one academic year (3 semesters/12 months) unless otherwise indicated
Academic Expenses	Tuition*	\$25,000.00-\$32,000.00 CAD	\$22,999.98-\$30,000.00 CAD / MBA: \$37,800.00-\$45,800 CAD*
	Ancillary Fees	\$1,257.13-\$1,382.13 CAD (Varies depending on program)	\$737.73 CAD
	Books <sup>\$</sup>	\$1,000-\$2,000 CAD	\$1,000-\$2,000 CAD
	<b>Total Academic Expenses</b>	<b>\$27,257.13 - \$35,382.13 CAD</b> per academic year (8 months)	<b>\$24,737.71-\$32,737.73 CAD / MBA: \$39,537.73-\$48,537.73 CAD*</b> per academic year (12 months)
Living Expenses	Housing	<b>ON-CAMPUS</b> Dorm-style with meal plan: \$11,066-\$13,334 CAD Townhouse & Apartment without meal plan: \$7,462.00-\$7,873.00 CAD <b>OFF-CAMPUS</b> 2 bedroom apartment: \$8,000-\$9,600 CAD <sup>†</sup>	<b>ON-CAMPUS</b> Townhouse & Apartment without meal plan: \$10,587-\$11,023 CAD <b>OFF-CAMPUS</b> 2 bedroom apartment: \$12,000-\$14,400 CAD <sup>†</sup>
	UHIP (University Health Insurance Plan)	\$720 CAD/year (single rate)	\$720 CAD/year (single rate)
	Food (if you do not have a residence meal plan)	\$400-\$500 CAD Varies depending on your food choices and the amount you eat.	\$400-\$500 CAD Varies depending on your food choices and the amount you eat.
	Personal Expenses	\$1,500 CAD	\$2,250 CAD
	<b>Total Living Expenses</b>	<b>\$12,882 (on-campus Apartment) - \$15,820 CAD (off-campus)</b> per academic year (8 months)	<b>\$18,357 (on-campus Apartment) - \$23,370 CAD (off-campus)</b> per academic year (12 months)

Amounts are in Canadian dollars and reflect the 2020-2021 regular academic year prices.

\* Tuition varies by program. All Graduate students are required to register and pay for three terms per year, until graduation.

<sup>‡</sup> First amount reflects the cost for the 12-month MBA, and the second for the 16-month MBA

<sup>\$</sup> The cost of books varies greatly depending on whether you purchase new or used books, what program you are in, and what the professor's syllabus is for the year.

<sup>†</sup> The cost of off-campus housing varies depending on location, size, whether you are sharing accommodation with others, and whether utility costs are included.



# OUR PROGRAMS

Lakehead University is celebrated as one of Canada's leading academic institutions with a broad range of programs. Whether you enter directly into one of our undergraduate or graduate programs, or begin your studies by upgrading your English language skills first, we have an option for you.

## AREAS OF STUDY

Lakehead University has more than 85 programs that are grouped within 10 Faculties for a comprehensive selection of academic areas of study:



**BUSINESS ADMINISTRATION**  
PAGE 34



**ENGINEERING**  
PAGE 36



**SCIENCE & ENVIRONMENTAL STUDIES**  
PAGE 38



**NATURAL RESOURCES MANAGEMENT**  
PAGE 40



**EDUCATION**  
PAGE 41



**SOCIAL SCIENCES & HUMANITIES**  
PAGE 42



**HEALTH & BEHAVIOURAL SCIENCES**  
PAGE 44



**LAW**  
PAGE 45



**MEDICINE**  
PAGE 45



**GRADUATE STUDIES**  
PAGES 34-44



## SMALL CLASS SIZES

STUDENTS TO PROFESSORS

**15:1**  
Thunder Bay  
Campus

**13:1**  
Orillia  
Campus

## LEVELS OF STUDY

Lakehead University features programs at all three levels of post-secondary study.

### UNDERGRADUATE PROGRAMS

Lakehead offers bachelor and honours bachelor programs in 60+ fields within 10 faculties of study. Tailor your degree with specializations, double-degree combinations, concentrations, or minors.

### MASTERS PROGRAMS

Building on an undergraduate degree you can choose from 28 different Masters programs from 8 faculties of study. Explore either thesis-based, course-based or project-based options depending on your graduate degree.

### DOCTORAL PROGRAMS

At the highest level of academic study, Lakehead offers 8 doctoral programs in 6 faculties of study. Explore your field more deeply through specialized research and study.

## ACADEMIC SUPPORTS

- ✓ **Student Success Advising** - One-on-one counselling on transitioning to university, time management, and goal setting.
- ✓ **Skills for Success Workshops** - Free sessions offered to learn strategies on academic writing and integrity, effective textbook reading and note-taking, and exam preparation.
- ✓ **Tutoring & Peer-Assisted Learning** - Free group tutoring sessions to help ensure you are mastering the material in your classes.
- ✓ **Writing Centre** - Writing coaches help you with written assignments by teaching you how to develop an argument, organize your ideas, edit your own work, and use proper citations.
- ✓ **Library** - Access our modern libraries network featuring extensive research databases and online resources (not to mention books) that our friendly and student-oriented library staff will help you navigate.
- ✓ **Student Accessibility Services** - If you have a documented disability, access the services of this office for assistance with accommodations and supports to achieve success in your classes and exams.

### English Language Centre (page 56)

Lakehead University offers a wide variety of English language courses in order to help you meet your educational, professional and personal goals. From beginner to university level, we have a program that will get you there.



# BUSINESS ADMINISTRATION & COMMERCE

**100% EMPLOYED TWO  
YEARS AFTER GRADUATION**



## NOT ALL BUSINESS SCHOOLS ARE CREATED EQUAL.

Fewer than 5% of business programs worldwide have been accredited by the Association to Advance Collegiate Schools of Business (AACSB) and Lakehead University's Thunder Bay campus is one of them. This globally-recognized hallmark of excellence guarantees a challenging and relevant curriculum delivered by the most highly-qualified faculty.

A business education at Lakehead will prepare you to navigate the increasing complexities of the global business environment. We connect you to the business world with theory and hands-on practical applications combined. Our lectures and seminars are infused with experiential learning, teamwork and open discussion.

With guaranteed smaller class sizes, you will work in small group settings while interacting closely with your instructors. Our classes include a variety of experiential learning activities that allow you to put theory into action while refining your ability to think critically, work effectively in teams, communicate, and problem solve – all skills employers look for in future hires.

[lakeheadu.ca/explore-business](http://lakeheadu.ca/explore-business)

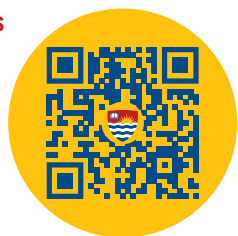

## LAUNCH YOUR FUTURE CAREER FORWARD WITH A PROFESSIONAL DESIGNATION

A Lakehead business degree will help you fast track, attaining professional designations that will allow you to enter into specific careers that require a certain set of skills and expertise.

- ▶ We are accredited by Chartered Professional Accountants (CPA) of Ontario. Accounting majors graduate with all of the requirements of the CPA Prerequisite Education Program (PREP).
- ▶ Our courses have been approved by the Human Resources Professionals Association for use toward one of the Certified Human Resources designations (CHRP, CHRL, CHRE). Human Resources Management majors graduate with all of the courses required.



**INGENUITY IS A LAKEHEAD UNIVERSITY BUSINESS INCUBATOR** that offers space, resources, support, and funding to students who are looking to start a business or develop their business ideas. Through workshops, competitions and one-on-one support, Ingenuity helps students transition their ideas to launch.

## UNDERGRADUATE PROGRAMS

- ▶ **Bachelor of Administration (BAdmin)** T O
- ▶ **Honours Bachelor of Commerce (HBComm)**

Majors available:

- Accounting\* T
- Business Administration\* O
- Business Economics T
- Finance\* T
- General Management T
- Global Entrepreneurship\* O
- Human Resources Management /Industrial Relations\* T
- Information Systems\* T
- International Business T
- Marketing\* T
- ♦ Co-operative Education Option Available

## MASTERS PROGRAMS

- ▶ **Master of Business Administration (MBA)\*** T  
12 months
- ▶ **Master of Business Administration (MBA) with Advanced Studies in Management\*** T  
16 months
- ▶ **Master of Business Administration (MBA) with a Bachelor of Engineering\*** T  
(see page 37)
- ▶ **Master of Science in Management (MScMGT)** T

### Business Skills Development Program T

Course-based program that may be used to meet the GMAT/GRE requirement for admission to the MBA program. Applicants are automatically considered as part of MBA admissions process.

\* These Masters programs offer a course-based option

## RBC WORK-INTEGRATED LEARNING PROGRAM

Gain sought-after workforce skills, confidence and knowledge by participating in integrated learning opportunities including mentorship and an experiential learning placement.

## OUTSTANDING ALUMNI



### Peter Lau, Hong Kong SAR (China) Business Administration Graduate

- ▶ Founder of Asia One Communications Group, one of the top 5 commercial printing houses in Hong Kong
- ▶ Winner of the Outstanding SME Social Responsibility Award from The Mirror Post in 2015
- ▶ Winner of the Hong Kong Award for Industry in 2015
- ▶ Founder of the AO Vertical Art Space, one of Hong Kong's most unusual galleries

“My school life in Canada was a good training ground in terms of independence and leadership, which laid the foundation for my career in the business world.”

Studying in a Canadian northern university was completely beyond my childhood imagination and planning. The most important things that I learned were adaptive skill and agility.”



## THE CO-OPERATIVE EDUCATION ADVANTAGE



Gain hands-on experience in the business world. With co-op work terms of 4 to 16 months in duration, you will work in a role directly suited to your major while earning a competitive salary. Co-operative Education employers include IBM, BlackBerry, RBC, HSBC, BMO, BDO, Grant Thornton, Hydro One, Thunder Bay Regional Health Sciences Centre, and many more.

## CAREER OUTCOMES

- |                         |                     |                           |
|-------------------------|---------------------|---------------------------|
| ▶ Marketing Director    | ▶ CEO               | ▶ Economist               |
| ▶ Investment Banker     | ▶ Financial Analyst | ▶ International Relations |
| ▶ Entrepreneur          | ▶ Systems Designer  | ▶ Executive Recruiter     |
| ▶ Lawyer                | ▶ HR Specialist     | ▶ Auditor                 |
| ▶ Real Estate Developer | ▶ Sales Director    | ▶ Controller              |
| ▶ Chartered Accountant  |                     |                           |

**\$50,000+ AVERAGE ANNUAL SALARY 2 YEARS AFTER GRADUATION**

T Thunder Bay Campus O Orillia Campus



DEGREE + DIPLOMA IN 4 YEARS

# ENGINEERING

**Gain the advantage with Lakehead's Unique Engineering Programs. Earn a Bachelor of Engineering Degree and a Diploma in Engineering Technology in just 4 Years.**

Lakehead's unique Engineering program attracts students from across Canada and the world. You will have access to professors who are active researchers, conducting cutting-edge studies.



With undergraduate and graduate student involvement, Lakehead's Engineering research has led to developments in wide ranging areas such as forest biorefining, computational fluid dynamics, renewable energy, HVAC, thermal and power systems, electronics and photonics, and semiconductor materials.

Our students participate in many team-based learning opportunities, including projects and presentations, hands-on laboratories, and a senior design project. Enhance your education by participating in our engineering speaker's series, tours, volunteer opportunities, Technical and Professional Chapters, engineering competitions, and a variety of on-campus and community events.

At Lakehead, we believe engineers must also possess excellent communication skills as well as an understanding of the management, legal, and societal issues that impact development of the technological products and processes required to meet the demands of a global economy.

[lakeheadu.ca/explore-engineering](https://lakeheadu.ca/explore-engineering)



All Thunder Bay Bachelor of Engineering Degree Programs are accredited by **The Canadian Engineering Accreditation Board (CEAB)**



**96.3%**  
EMPLOYED 2 YEARS  
AFTER GRADUATION



## THE CO-OPERATIVE EDUCATION ADVANTAGE

Gain hands-on experience in the engineering world. You will accumulate at least 16 months of paid, practical work experience related to your degree program while earning a competitive salary. You can choose Co-op when you apply to Lakehead, or apply to Co-op while you are in second or third year. Co-operative Education employers include IBM, BlackBerry, Shell Suncor, Honda, Siemens, Bombardier, Bell, and many more.

## UNDERGRADUATE PROGRAMS

- Chemical Engineering\*
- Chemical Engineering + MBA\*
- Civil Engineering\*
- Civil Engineering + MBA\*
- Electrical Engineering\*
- Electrical Engineering + MBA\*
- Mechanical Engineering\*
- Mechanical Engineering + MBA\*
- Software Engineering\*
- Software Engineering + MBA\*

\* Co-operative Education Option Available

\* These Masters programs offer a course-based option



**BACHELOR OF ENGINEERING IN  
4 YEARS + MBA IN 5 YEARS**

## CAREER OUTCOMES

- |                        |                             |                          |
|------------------------|-----------------------------|--------------------------|
| Chemical Engineer      | Geotechnical Engineer       | Automotive Engineer      |
| Process Engineer       | Electrical Engineer         | Manufacturing Engineer   |
| Environmental Engineer | Telecommunications Engineer | Thermal Engineer         |
| Civil Engineer         | Electronics Engineer        | Software Engineer        |
| Structural Engineer    | Mechanical Engineer         | Computer Engineer        |
| Municipal Engineer     | Aeronautical Engineer       | Web Development Engineer |

**\$65,400+ AVERAGE ANNUAL SALARY 2 YEARS AFTER GRADUATION**

### Photo Captions

1. Engineering students learn how to use the Prusa i3 MK3 3D printer in the Makerspace
2. Formula SAE Mechanical Engineering students working on their Formula SAE race car
3. Building a drone in an electrical engineering lab
4. Students in the structures lab

## MASTERS PROGRAMS

- Chemical Engineering
- Civil Engineering\*\*
- Electrical and Computer Engineering\*\*
- Environmental Engineering\*\*
- Mechanical Engineering\*\*

## DOCTORAL PROGRAMS

- Doctor of Philosophy in Engineering (Electrical & Computer)

## OUTSTANDING ALUMNI



**Muhammad Kabir Hossain,  
Bangladesh**

**Bachelor of Engineering (Electrical)  
Graduate  
Eaton, Product Engineer**

“When anybody asks me where I got my degree from, I proudly say Lakehead. When you graduate from high school, you might have the dream to get into those big schools, but it's easy to get lost there.

At Lakehead, the professors pay very good attention to the students, and they know everybody by name, so you can actually reach your goals. A lot of the projects we did in university, we did as a team, so when it came to real life, it played an important role in how I succeed in a team environment and how good I am with my colleagues and customers”.



Thunder Bay Campus Orillia Campus Lakehead-Georgian



# SCIENCE & ENVIRONMENTAL STUDIES

Lakehead University's geographic locations in northwestern and central Ontario present a perfect natural laboratory for your education in the disciplines of science and environmental studies.

Not only will you gain firsthand knowledge and experience in your field of study both inside and outside the classroom, you will also have opportunities to be engaged in exciting research projects, working alongside leading scientists on projects that inspire your learning while you contribute towards the creation of new knowledge.

Both of our campuses provide you with the enriched learning environments that only smaller class sizes can offer, as well as invaluable fieldwork and laboratory work starting right in your first year, using sophisticated, state-of-the-art tools and equipment. Lakehead offers a wide range of science programs that will prepare you to become a future scientist, ground-breaking researcher or lead you to a wide range of other career opportunities.

🔗 [lakeheadu.ca/explore-ses](https://lakeheadu.ca/explore-ses)

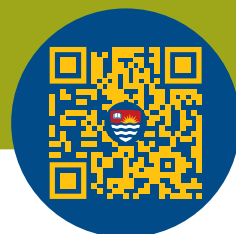

## Photo Captions

1. A student works with a technician on the X-ray photoelectron spectroscopy (XPS) in the Centre for Analytical Services
2. Dr. Vijay Mago speaking with Computer Science students in the Data Centre
3. Lakehead University's Paleo-DNA Lab



**OUR ENVIRONMENTAL PROGRAMS ARE NATIONALLY-ACCREDITED THROUGH ECO-CANADA**

Lakehead University is home to 25 Research Labs, Centres and Institutes including those in the new Centre for Advanced Studies in Engineering and Sciences (CASES). Here students are engaged in faculty research projects on topics such as Nano-Materials and Advanced Technologies, Community Ecology Energetics, and Human Origins.



## UNDERGRADUATE PROGRAMS

- ▶ Anthropology T O
- ▶ Applied Life Sciences T O LG
- ▶ Bioinformatics T
- ▶ Biology T
- ▶ Chemistry T 100%
- ▶ Computer Science\* T LG 100%
- ▶ Earth Science T
- ▶ Economics T
- ▶ Environmental Studies/Science T
- ▶ Environmental Sustainability\* O LG
- ▶ General Science T O
- ▶ Geoarchaeology T
- ▶ Geography and the Environment T O
- ▶ Geology T 100%
- ▶ Lakehead Science One\* T O
- ▶ Mathematics T
- ▶ Mathematical Physics T
- ▶ Natural Science T
- ▶ Physics\* T 100%
- ▶ Resource and Environmental Economics T
- ▶ Water Resource Science T

## MASTERS PROGRAMS

- ▶ Archaeological Sciences T
- ▶ Biology T
- ▶ Chemistry T 100%
- ▶ Computer Science\*\* T 100%
- ▶ Economics\*\* T
- ▶ Geology T 100%
- ▶ Mathematical Sciences\*\* T
- ▶ Environmental Studies T
- ▶ Physics\* T 100%

## DOCTORAL PROGRAMS

- ▶ Doctor of Philosophy in Chemistry and Materials Science T
- ▶ Doctor of Philosophy in Biotechnology T

♦ Co-operative Education Option Available  
\* These Masters programs offer a course-based option

❖ Choose from the following streams:

- O Life Sciences, Geo-environmental Sciences, and Science Foundations
- T Physical Science, Life Sciences, Geo-environmental Sciences, Science and Policy, and Science Foundations

**100% EMPLOYMENT RATE 2 YEARS AFTER GRADUATION**

## CAREER OUTCOMES

- |                          |                                      |                           |
|--------------------------|--------------------------------------|---------------------------|
| ▶ Toxicologist           | ▶ Veterinarian                       | ▶ Optometrist             |
| ▶ Forensic Examiner      | ▶ Geochemist                         | ▶ Petrophysicist          |
| ▶ Horticulturist         | ▶ Diagnostic Audiologist/Radiologist | ▶ Actuary                 |
| ▶ Mycologist             | ▶ Meteorologist                      | ▶ Industrial Hygienist    |
| ▶ Naturopathic Physician | ▶ Nuclear Physicist                  | ▶ X-Ray Technician        |
| ▶ Exploration Geologist  | ▶ Oceanographer                      | ▶ Environmental Scientist |
| ▶ Pharmacist             |                                      | ▶ Geomatics Technician    |

T Thunder Bay Campus O Orillia Campus LG Lakehead-Georgian



## THE CO-OPERATIVE EDUCATION ADVANTAGE

Gain hands-on experience in the working world. With co-op work terms of 4 to 16 months in duration, you will work in a role directly suited to your major while earning a competitive salary. Co-operative Education employers include Hydro One, Grant Thornton, IBM, Thunder Bay Regional Health Sciences Centre, BlackBerry, and many more.

## OUTSTANDING ALUMNI



**Khalid Adam Osman Yahia, Sudan**  
Honours Bachelor of Science (Geology) Graduate  
Geologist at Rio Tinto

“During my degree, I gained hands on experience through field school and by working for a mining company in the summer.

As soon as I graduated, I started a new job, and Lakehead helped me prepare for it. Not only was the chair of my program very helpful during my studies, but my classmates were also supportive.”





# NATURAL RESOURCES MANAGEMENT

## We're more than trees — a modern approach to the stewardship of the environment – in an unbeatable setting.

At Lakehead, we believe Natural Resources Management is about people, science and technology, and applying natural and social sciences to the management of the environment for the benefit of society.

Stewardship allows for the protection of forested landscapes for recreational pursuits, as well as the sustainable extraction and utilization of products such as wood, biofuels, bioproducts, food, and natural medicines. With a balanced view of the social, economic and environmental challenges of stewardship, Lakehead's programs will prepare you to take an active and responsible role in the sustainability of the world's most important resources.

[lakeheadu.ca/explore-nrm](https://lakeheadu.ca/explore-nrm)

### UNDERGRADUATE PROGRAMS

Whether you are interested in the Honours Bachelor of Science in Forestry (HBSf) or the Honours Bachelor of Environmental Management (HBEM), you will follow a common curriculum for the first two years of your program.

#### ► Environmental Management\* T 100%

Three specialization options: Wildlife Conservation & Management, Conservation Planning & Management, and Sustainable Land Use

#### ► Forestry\* T 100%

Three specialization options: Forest Management, Forest Health & Protection, and Forest Products & Marketing

### CAREER OUTCOMES

- Geomatics Specialist
- Urban Forester
- Wildlife Ecologist
- Fish & Wildlife Officer
- GIS Forester
- Invasive Species Specialist
- Community/Economic Development Officer
- International Conservation Specialist
- Renewable Energy Consultant
- Climate Change Analyst
- Planning Forester
- Forestry Consultant

### MASTERS PROGRAMS

#### ► Science in Forestry\* T 100%

### DOCTORAL PROGRAMS

#### ► Doctor of Philosophy in Forest Sciences T 100%

- ♦ Co-operative Education Option Available
- \* This Masters program offers a course-based option

**100%** EMPLOYMENT RATE  
2 YEARS AFTER GRADUATION

**CO-OPERATIVE EDUCATION: GET PAID WORK EXPERIENCE**

### A GLOBAL PERSPECTIVE

Take your skills and passion across the world with the option to participate in an international field school excursion as well as internationally-focused courses.

### OUTSTANDING ALUMNI



#### Siyao (Sharon) Yang, China

Honours Bachelor of Environmental Management Graduate, Master of Science in Forestry Graduate  
NOHFC Lab Intern, Thunder Bay Regional Health Sciences Centre

**“I enjoyed studying in small-sized classes because this offered me more opportunities to participate in class.”**

Field school was the best hands-on experience I ever had. We got the chance to see nature in Thunder Bay, different places in Canada, and even around the world. During field school, we collected data under the instruction of professors. Later this data was used in class projects. Putting what we learned into practice, with the help of professors, was amazing.”



# TEACHER EDUCATION

Lakehead has a rich history educating future educators. Our approach supports the discovery of your own teaching style while exposing you to real world challenges, which allows you to create inspiring educational experiences.

This will prepare you to be a leader in a variety of disciplines that shape education, not just in Canada, but also around the globe. Your Lakehead degree may lead you to be a classroom teacher in your hometown, in another province, or internationally. The skills and experience you gain may also lead you to non-traditional educational settings such as adult education, English language schools, training organizations, children and community development associations, and many more.

[lakeheadu.ca/explore-education](https://lakeheadu.ca/explore-education)

### UNDERGRADUATE PROGRAMS

- Concurrent Education - Primary/Junior T O
- Concurrent Education - Intermediate/Senior T
- Consecutive Education - Primary/Junior T O
- Consecutive Education - Intermediate/Senior T
- Aboriginal Education - Primary/Junior T
- Indigenous Teacher Education Program - Intermediate/Senior T
- Indigenous Languages Teacher Diploma Program - Primary/Junior T O

**95.2% EMPLOYMENT RATE  
2 YEARS AFTER GRADUATION**

**GAIN EXCEPTIONAL INSIGHT AND  
ON-THE-JOB TRAINING:  
105 DAYS OF PLACEMENT**

### CAREER OUTCOMES

- Primary/Junior Teacher
- Principal
- Second Language Teacher
- Intermediate/Senior Teacher
- Writer
- Education Director
- School Counsellor
- Adult Literacy Teacher
- Athletics Director
- Youth Worker

### MASTERS PROGRAMS

- Education for Change\* T
- Specializations in Environmental and Sustainability Education, Indigenous Education, and Social
- Justice Education
- Educational Studies\* T
- Optional specializations in Gerontology and Gender & Women's Studies

### DOCTORAL PROGRAMS

- Doctor of Philosophy in Educational Studies T
- Specializations available in Cognition and Learning, Social/Cultural/Political Contexts, or Leadership and Policy Studies

\* These Masters programs offer a course-based option

### PASSPORT TO THE WORLD: INTERNATIONAL OPPORTUNITIES

Our International Field Experience program opens opportunities for you to gain valuable experience with partner schools in the United Kingdom, Malaysia, China, and the Caribbean.

### OUTSTANDING ALUMNI



#### Sadaf Rahman Khan, India Master of Education Graduate

**“I worked as a teacher for a long time before making a decision to upgrade my education.”**

I chose Lakehead University because it provides a high standard of education, yet is very affordable both in terms of academic and living costs. Classes are small and it is easier to know your peers and professors. I always felt a kind of bonding among my classmates and with professors. Lakehead has provided me with great experience and a high class education. It helped me to explore myself and to understand what I am capable of on my own.”



### ACCELERATED DEGREE OPTION

Complete your 4-year undergraduate degree and 2-year Education degree in just 5 years. Majors include: Biology, Chemistry, English, History Interdisciplinary Studies and Kinesiology.





# SOCIAL SCIENCES & HUMANITIES

**Make a difference. Be the change you want to see in the world.**

Join the next generation of global citizens in one of our engaging Social Sciences and Humanities programs. You will thrive in our dynamic and vibrant learning environment, with small classes, high-impact practices, and award-winning faculty who know your name and engage in your success.

Explore the diversity of human experience across time and place, and investigate the ways in which meaning is made, how our world views are represented, and how new ideas take hold and shape us and our world. In the Social Sciences and Humanities we explore those large and enduring questions related to the ways in which human beings think and behave, how they interact with each other and their environment, and how they communicate ideas about human experience through a rich range of research topics. Lakehead is one of Canada's top 10 primarily undergraduate universities for Social Sciences and Humanities Research, and offers you the opportunity to gain experiences that combine academic studies with community-based and hands-on learning through a social justice lens.

Our graduates are ready to make a difference in our communities and our world.

[lakeheadu.ca/explore-ssh](https://lakeheadu.ca/explore-ssh)

### Photo Captions

1. An English literature class discussion
2. A political science class with Dr. Zubairu Wai
3. An Outdoor Recreation class exercise



**TOP 10** PRIMARILY UNDERGRADUATE UNIVERSITIES FOR SOCIAL SCIENCES & HUMANITIES RESEARCH (Maclean's 2020)



**ATCE** THE OUTDOOR RECREATION PROGRAM IS ONE OF A KIND IN CANADA

### UNDERGRADUATE PROGRAMS

- ▶ Criminology **O**
- ▶ English **T O**
- ▶ General Arts **T O**
- ▶ History **T O**
- ▶ Indigenous Learning **T**
- ▶ Interdisciplinary Studies **O**
- ▶ Lakehead Arts One **T**
- ▶ Languages **T**
- ▶ Media, Film & Communications **O**
- ▶ Music **T**
- ▶ Outdoor Recreation, Parks & Tourism **T**
- ▶ Philosophy **T**
- ▶ Political Science/Pre-Law **T O**
- ▶ Sociology **T O**
- ▶ Visual Arts **T**
- ▶ Women's Studies **T**

### MASTERS PROGRAMS

- ▶ English\* **T**
  - ▶ History\* **T**
  - ▶ Social Justice\* **T**
  - ▶ Sociology **T**
- Women's Studies Specializations Available.
- \* These Masters programs offer a course-based option



### DOUBLE MAJOR

Many of our Social Sciences & Humanities programs have the option to pursue two majors at the same time!

### CAREER OUTCOMES

- |                          |                          |                    |
|--------------------------|--------------------------|--------------------|
| ▶ Community Organizer    | ▶ Operations Supervisor  | ▶ Teacher          |
| ▶ Cultural Arts Director | ▶ Police Officer         | ▶ Team Coordinator |
| ▶ Editor                 | ▶ Policy Analyst         | ▶ Translator       |
| ▶ Program Manager        | ▶ Project Manager        | ▶ Web Designer     |
| ▶ Mediator               | ▶ Recreation Coordinator | ▶ Writer           |
| ▶ Musician               | ▶ Social Media Director  |                    |

**T** Thunder Bay Campus **O** Orillia Campus



### OUTSTANDING STUDENT

**Hai Yen (Yvonne) Hoang, Vietnam**  
Media, Film & Communications Student

**“ I am interested in the study of film, television and images.**

I'm looking forward to learning more about film production and photography. My program is interdisciplinary, so I am taking a wide range of classes. For example, I loved "Environment in Politics and Culture" with Professor Alex Thomson, who is an amazing woman. She helped me a lot in understanding Indigenous issues in Canada, and I learned many new things. She is friendly with students, and she remembers everyone's name, which is really cool."





# HEALTH & BEHAVIOURAL SCIENCES

Our health matters.  
We make it a priority to play an active role.

Human health and well-being is of interest to everyone, from private citizens to officials at the highest level of government across the globe. Whether you choose to study one of our health-related or behavioural sciences programs, you will be immersed in an environment filled with innovative research and educational programming that will ensure you can play an active role in meeting the ever-changing demands of the healthcare sector.

🔗 [lakeheadu.ca/explore-hbs](https://lakeheadu.ca/explore-hbs)

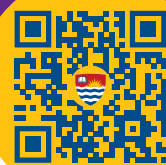

## UNDERGRADUATE PROGRAMS

- ▶ Kinesiology <sup>T</sup>
- ▶ Nursing <sup>T</sup>
- ▶ Psychology <sup>T</sup>
- ▶ Social Work <sup>T</sup> <sup>O</sup>
- Co-operative Education Option Available

## MASTERS PROGRAMS

- ▶ Health Sciences <sup>T</sup>
- ▶ Kinesiology <sup>T</sup>
- ▶ Psychology: Clinical <sup>T</sup>
- ▶ Psychology: Psychological Science <sup>T</sup>
- ▶ Public Health\* <sup>T</sup>
- ▶ Social Work <sup>T</sup>

Gerontology and Nursing Specializations available

## DOCTORAL PROGRAMS

- ▶ Doctor of Philosophy Clinical Psychology <sup>T</sup>
- ▶ Doctor of Philosophy Health Sciences <sup>T</sup>
- ▶ Doctor of Philosophy Psychological Science <sup>T</sup>

\* This Masters program offers a course-based option.

## CAREER OUTCOMES

- ▶ Kinesiologist
- ▶ Teacher
- ▶ Physiotherapist
- ▶ Sports Medicine Specialist
- ▶ Policy Analyst
- ▶ Social Worker/Counsellor
- ▶ Occupational Therapist
- ▶ Physician
- ▶ Ergonomist
- ▶ Exercise Therapist
- ▶ Psychologist
- ▶ Nurse/Nurse Practitioner
- ▶ Epidemiologist

<sup>T</sup> Thunder Bay Campus <sup>O</sup> Orillia Campus

PUT THEORY INTO PRACTICE  
WITH LABS, INTERNSHIPS  
AND PLACEMENTS

## OUTSTANDING ALUMNI



**Opeyemi Adeoye, Nigeria/Canada**  
**Honours Bachelor of Science in Nursing Graduate**  
Registered Nurse, Thunder Bay Regional Health Sciences Centre

“The clinical placement program allowed me to work in different hospital departments. It was a good experience having placements directly on the floor with experienced nurses to help build relationships and trust. Even now I work with some of my past professors in the hospital. Because they work in the profession while teaching, they are able to share their knowledge and understanding with students in the classroom. Lakehead made me see that education is not just a gateway to a job.”



## NON-DIRECT ENTRY PROGRAMS THUNDER BAY CAMPUS

## LAW

An innovative and personal legal education.  
Fusing theory with practical application.

At Lakehead, we provide the highest standard of legal education. Our Juris Doctor program focuses on the realities of living and working in the North.

We are small. With only 65 students every year, we take full advantage of our small class size. You will receive a personal education, where learning is hands on and your professors are available to you. We offer unique opportunities for you to hone your legal skills at all stages of the program. Lakehead law graduates are ready to serve their communities as skilled advocates and admitted to the Ontario bar without requiring articles of clerkship.

The Bora Laskin Faculty of Law has three mandates that guide our delivery of an innovative practice-ready focused curriculum:

- ▶ Aboriginal and Indigenous Law
- ▶ Natural Resources and Environmental Law
- ▶ Small Firm and Solo Practice with the Integrated Practice Curriculum (IPC)

🔗 [law.lakeheadu.ca](https://law.lakeheadu.ca)

## MEDICINE

A medical school like no other. Born of  
a grassroots movement by Northern  
Ontarians in need of health professionals.

At NOSM, you will experience small class sizes, supportive faculty and staff, and the cultural immersion and research opportunities that define our internationally recognized MD program. Your learning journey will demonstrate the joys and challenges of practising in the North.

As a NOSM learner, you will live and learn in some of the 90 communities across NOSM's wider campus of Northern Ontario. Beginning in the first week of school, you will discover the health-care needs of people in the North, including Indigenous, Francophone, rural, and remote populations. Your education will incorporate interactive and virtual learning experiences, the determinants of health that are relevant to the North, a diverse learning and research community, with an emphasis on social accountability.

NOSM offers the following academic programs:

- ▶ MD Program
- ▶ Postgraduate Medical Education
- ▶ Northern Ontario Dietetic Internship Program
- ▶ Physician Assistant Program

🔗 [nosm.ca](https://nosm.ca)



# LAKEHEAD-GEORGIAN DEGREE+DIPLOMA

Innovative degree+diploma programs that allow you to combine the best of academic scholarship and applied skills.

Experience the best of both university and college –  
Earn a degree+diploma in just four years.

Launched by Canada's Lakehead University and Georgian College, our innovative degree+diploma programs integrate theoretical learning with a blend of applied skills you need to be job ready. While earning a university degree and a college diploma in four years of full-time study, you will have learning opportunities that go beyond the classroom and into our local and global communities and workplaces.

[lakeheadgeorgian.ca](https://lakeheadgeorgian.ca)

THE BEST OF BOTH  
WORLDS  
DEGREE+DIPLOMA  
IN 4 YEARS



“ This program allows me to earn both a diploma and degree at the same time, so by the time some people have earned only a degree or a diploma, I will earn both.

The smaller class sizes at Lakehead-Georgian mean that I get personalized help because the teacher-student connection is so strong. I am still in contact with my previous professors, and sometimes we even discuss projects or possible jobs.”

Sergio Beltran Obiol, Spain  
Computer Science Student



## UNDERGRADUATE PROGRAMS

### Computer Science<sup>2</sup>

*Honours Bachelor of Science Degree in Computer Science + Computer Programming Diploma*

Think big as you explore the world of computer science while engaging in a focused program stream. Master the technology that is rapidly revolutionizing our world. Students will have opportunities to develop advanced analytical, programming and software development skills, and participate in our co-operative education program to gain rewarding industry experience. First-year courses include Programming Fundamentals, Introduction to Entrepreneurship, Discrete Mathematics, Introduction to Object Oriented Programming using Java, Client-Side JavaScript, Introduction to Web Programming using PHP, Advanced Databases, and more.

### Applied Life Sciences<sup>2</sup>

*Honours Bachelor of Science Degree in Applied Life Sciences (Specialization in Biomedical Techniques) + Biotechnology-Health Diploma*

Prepare for a career in biotechnology, forensics, diagnostic laboratories, or the health sector. You'll explore diverse topics to understand the extent of biological diversity at the molecular level and develop critical thinking skills with respect to modern life science. Our focus on the practical application of your skills provides you with valuable laboratory and data analysis training. First-year courses include Animal Biology, Chemistry, Human Physiology, and Biomedical Laboratory, and more.

- Co-operative Education option is mandatory for the Computer Science program and optional for the Electrical Engineering program.

### Electrical Engineering<sup>1</sup>

*Bachelor of Engineering (Electrical) Degree + Electrical Engineering Technology Advanced Diploma*

Central Ontario's only innovative four-year engineering program provides you with a solid foundation across all areas of electrical engineering. Gain valuable theoretical knowledge, practical engineering and applied technology skills. You will participate in team-based learning opportunities, including projects and presentations, hands-on laboratories, and a senior design project. First-year courses include Electric Circuit Theory, Chemistry, Computer Programming, Calculus, Physics, and Introduction to Engineering Design.

### Environmental Sustainability<sup>2</sup>

*Honours Bachelor of Arts and Science – Environmental Sustainability (Specialization in Ecosystem Management) Degree + Environmental Technician Diploma*

Learn to tackle emerging environmental challenges and explore sustainable solutions – essential to creating a greener future. Graduate with advanced lab and field skills that will allow you to meet and adapt to the growing demands of this sector. First-year courses include Plant Biology, Canadian Forest Plant Species, Computer Technology for Environmental Applications, Inquiry into Environmental Methods, Environmental Thought and Policy, Animal Biology, and more.

<sup>1</sup> Years 1-4 Barrie Campus

<sup>2</sup> Years 1-2 Barrie Campus / Years 3-4 Orillia Campus

Lakehead-Georgian Campus

## CAREER OUTCOMES

- Electrical Engineer
- Engineering Project Manager
- Telecommunications Engineer
- Application Developer
- Software Engineer
- Security Specialist
- Ecologist
- Environmental Educator
- Environmental Compliance
- Officer
- Botanist
- Pharmaceutical Researcher
- Genetic Counsellor



## Rewarding Excellence

Admissions Average Canadian Equivalent	International Entrance Scholarship <sup>4</sup>	EXCLUSIVE International Visionary Award <sup>*</sup>	Scholarships + Awards Total Scholarship + Award	Scholarship + Award Allocation	
				Year 1	Years 2-4
90.0% & over	\$40,000 CAD <sup>1</sup> (\$10,000 x 4 years)	\$4,000 CAD	\$44,000 CAD over 4 years	\$14,000 CAD	\$10,000 CAD <sup>1</sup>
80.0% - 89.9%	\$30,000 CAD <sup>2</sup> (\$7,500 x 4 years)	\$4,000 CAD	\$34,000 CAD over 4 years	\$11,500 CAD	\$7,500 CAD <sup>2</sup>
75.0% - 79.9%	\$6,000 CAD <sup>3</sup> in year 1 only	\$4,000 CAD	\$10,000 CAD in year 1 only	\$10,000 CAD	
70.0% - 74.9%		\$4,000 CAD	\$4,000 CAD in year 1 only	\$4,000 CAD	

International Entrance Scholarships and Awards are automatically awarded, with no application required, to non-Canadian citizens who are entering Lakehead University from a recognized high school curriculum, or who are transferring from an international college or university. The scholarship is available to the top international high school students applying to Lakehead University for 2021-2022.

<sup>1</sup> \$10,000/year x 4 years. Renewable provided a 90% average is achieved in each academic year. If a student's university academic average falls between 80.0% - 89.9%, the student will receive an amended scholarship valued at \$7,500 CAD/year for each subsequent academic year for the remaining term of the scholarship.

<sup>2</sup> \$7,500/year x 4 years. Renewable provided an 80% average is achieved in each academic year.

<sup>3</sup> Non-renewable, one-time only scholarship awarded in Year 1.

<sup>4</sup> Maximum length of scholarship term is 4 academic years or until the first degree is awarded, whichever occurs first. Recipients whose status changes and may be charged domestic fees will have their scholarship value reassessed to equate to the domestic entrance scholarship grid and regulations available at that time.

<sup>\*</sup> International Visionary Award available for Fall 2021 entry.



# LAKEHEAD-GEORGIAN IN BARRIE

The City of Barrie, just a short one-hour drive north of Toronto, is the perfect place to enjoy a nurturing academic environment with easy access to Canada's largest city.

Barrie is home to one of the Lakehead-Georgian campuses with its special diploma+degree programs. The vibrant City of Barrie has a population of 153,000 and is known for its friendly residents and four-season lifestyle. Barrie boasts a gorgeous waterfront on Kempenfelt Bay, nearby trails and ski hills, several shopping malls, a vast assortment of restaurants and great nightlife.

[LEARN ABOUT YOUR NEW HOME!](https://lakeheadgeorgian.ca/campuses)  
[lakeheadgeorgian.ca/campuses](https://lakeheadgeorgian.ca/campuses)

**BARRIE IS AMONG CANADA'S  
TOP 3 SAFEST CITIES**

[TOURISMBARRIE.COM](https://tourismbarrie.com)



Photos courtesy of City of Barrie



# LAKEHEAD-GEORGIAN CAMPUS

As a Lakehead-Georgian student, you'll enjoy the best of what Lakehead University and Georgian College have to offer.

Although your time on campus may vary by program, you'll have access to all the amenities at both campuses. The Lakehead-Georgian Barrie Campus, where you will study in Year 1 of your diploma+degree program, is located in the heart of the City of Barrie. The campus offers a range of facilities including innovation labs, library, public clinics, student lounges, cafeteria and on-campus restaurants, theatres, videoconferencing classrooms, and a fitness centre with climbing wall and gymnasium.

[lakeheadgeorgian.ca/visitus](https://lakeheadgeorgian.ca/visitus)

## STUDENT SERVICES

Our small student population means that you have a community to rely on, whatever your needs. We encourage you to take advantage of the advice, assistance and supports offered to help you excel in your studies and to plan for the future.

Here are just a few services you can take advantage of:

- ▶ Segal International Centre
- ▶ Academic Planning & Support
- ▶ Peer Mentors & Tutoring
- ▶ Accessibility Services
- ▶ Counselling Services
- ▶ Co-operative Education & Career Success

**Single Room in Shared Space: 42m<sup>2</sup>**  
\$7,440 CAD\* for 8 months

- ▶ Private bedroom with double bed
- ▶ Shared bathroom
- ▶ Communal living/dining area and kitchen
- ▶ High-speed internet or WiFi

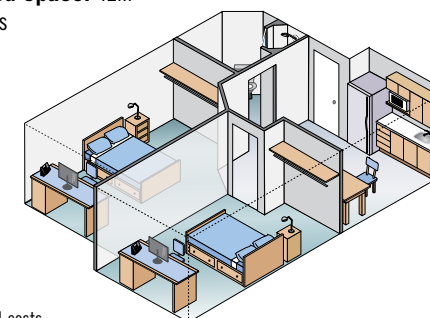

\*Prices are based on 2020-2021 costs.

## FOOD ON CAMPUS

Enjoy the convenience of multiple food outlets on campus including Tim Horton's, Subway, Pizza Pizza, a cafeteria, a student-run café and pub, and more. Load dining dollars onto your ONEcard and use it to pay for everything from cafeteria-style food including halal, gluten free, vegan, and international cuisine. Your ONEcard can also be used for select vendors and restaurants off campus.

## STAYING ACTIVE

Staying active and engaged is important to maintaining a healthy lifestyle while away at school. We make it easy here at Lakehead-Georgian by including athletic fees in your tuition. While studying at Lakehead-Georgian in Barrie, you'll automatically have access to the Athletic Centre on campus, which offers an impressive array of fitness facilities, programs and services. Enjoy one of our many fitness classes or make an appointment with a personal trainer.

## RESIDENCE

Your home away from home on campus is less than a five-minute walk from academic buildings. Our on-campus residence offers everything you need to make your first-year experience fun and safe. In residence you will have a private bedroom with double bed, shared kitchen and bathroom, as well as high-speed internet or WiFi. Another great way to immerse yourself and experience Canadian culture first hand is to participate in Homestay. You'll be carefully matched to one of our caring host families who will provide a private bedroom, food, and internet access.

[lakeheadgeorgian.ca/housing](https://lakeheadgeorgian.ca/housing)





# HOW TO APPLY

## UNDERGRADUATE APPLICATIONS:

- 1 **Explore Lakehead University's program options:** [lakeheadu.ca/programs](https://lakeheadu.ca/programs)
- 2 **Research admission requirements:** See pages 52-54 and visit: [lakeheadu.ca/international-admissions](https://lakeheadu.ca/international-admissions)
- 3 **Meet the English Language Requirements:** See page 55, or visit [lakeheadu.ca/language-proficiency](https://lakeheadu.ca/language-proficiency). If you do not meet the English language proficiency requirements for your academic program, you may be admitted conditionally provided you first complete the appropriate Academic English Program at Lakehead University.

- 4 **Apply online:** You can apply directly to Lakehead University online via the corresponding application to the program you are interested in studying. Visit: [lakeheadu.ca/international/applying](https://lakeheadu.ca/international/applying) to apply online and submit the application fee.

### Undergraduate Application Deadline Dates for Fall Entry:

January 29 - deadline to apply for Nursing

March 1 - recommended application deadline for all international undergraduate applicants for first-round Offer and scholarship consideration (Note: Application may remain open after this date until programs fill)

Program availability and application deadlines for winter and spring entries can be found at:

[lakeheadu.ca/undergraduate-application-deadlines](https://lakeheadu.ca/undergraduate-application-deadlines)

- 5 **Submit documents:** You will be required to submit documents to support your application. This will include official transcripts, English test scores (if required), and any other program-specific documents we request. You must mail original documents to:

**Lakehead University, Enrolment Services – Undergraduate Admissions**

955 Oliver Road, Thunder Bay, Ontario, Canada P7B 5E1

**Official Transcripts:** Conditional Letter of Acceptance may be extended based on scanned documents; however, for an unconditional Letter of Acceptance to be extended, you must mail original documents.

**Course Descriptions:** If you are transferring from a college or university and if you would like to be assessed for possible transfer credit, please submit detailed course descriptions. For details, visit: [lakeheadu.ca/admission-docs](https://lakeheadu.ca/admission-docs)

- 6 **Check the status of your application:** After you apply, we will send you an Acknowledgment email with your Lakehead student ID and myInfo login information. Be sure to keep this information. To check the status of your application, login to your myInfo account and see the details under the "Application" page.

- 7 **Check your Lakehead University email account:** Initialize your Lakehead email account using the login information sent to you in your Acknowledgment email and check it regularly for updates from Lakehead about course registration, orientation, travel preparation, and more.

- 8 **Accept your Offer:** If you receive a Letter of Acceptance, accept it online through myInfo (under the Application section) and pay the non-refundable deposit. Select programs may require you to accept your offer in an alternate method—follow the instructions in your Letter of Acceptance. The best way to pay deposits and fees is through Global Pay for Students.

For more details, visit: [lakeheadu.ca/international-fee-info](https://lakeheadu.ca/international-fee-info)

## NEXT STEPS:

**Apply for Visa and Immigration Documents:** Apply for a study permit that is valid for the entire duration of your studies. You may also require a Temporary Residence Visa (TRV). [lakeheadu.ca/immigration-docs](https://lakeheadu.ca/immigration-docs)

**Arrange Housing:** Have the full Lakehead experience, live on campus in residence. For details on housing options, visit: [lakeheadu.ca/residence](https://lakeheadu.ca/residence)

**Sign Up for Free Airport Pick-up:** As a new international student arriving in Thunder Bay or Orillia, you can request that we pick you up at the airport to make your arrival and transportation to campus easy and worry free. Look for the sign-up form in the Welcome package we will email after you accept your Letter of Acceptance: [lakeheadu.ca/airport-pickup](https://lakeheadu.ca/airport-pickup)

Prepare for your Lakehead adventure! For more details on the above steps, visit: [lakeheadu.ca/before-you-arrive](https://lakeheadu.ca/before-you-arrive)

## GRADUATE APPLICATIONS:

- 1 **Explore Lakehead University's program options:** [lakeheadu.ca/graduate-programs](https://lakeheadu.ca/graduate-programs)
- 2 **Research admission requirements:** See bottom of page 52 and visit [lakeheadu.ca/graduate-programs](https://lakeheadu.ca/graduate-programs), click on your program of choice, then click "Requirements" near the top of the program entry.
- 3 **Meet the English language requirements:** See page 55 or visit: [lakeheadu.ca/graduate-language-proficiency](https://lakeheadu.ca/graduate-language-proficiency). If you do not meet the English language proficiency requirements for your academic program, but otherwise meet the requirements, you may be admitted conditionally provided you first complete the appropriate Academic English Program at Lakehead University.

Note: Graduate applicants must apply to the term of entry when they will have met all requirements for admission. Letters of Acceptance to a graduate start term cannot be deferred to a later term.

- 4 **Apply online:** [lakeheadu.ca/graduate-applications](https://lakeheadu.ca/graduate-applications). Submit your application and fee online. On this site you will find links and instructions about which official and unofficial documents need to be submitted.

### Graduate Application Deadline Dates for Fall Entry:

February 1 - Recommended application deadline

Oversubscribed programs may close on or near February 1.

Program availability and application deadlines for winter and spring entries may be found at:

[lakeheadu.ca/graduate-applications](https://lakeheadu.ca/graduate-applications)

- 5 **Initialize your Lakehead email and myInfo accounts:** Once we receive your application and fee, we will send you an email to the address indicated in your application. This email will contain your student ID number, username and password for your new Lakehead email and myInfo accounts.
- 6 **Upload Documents:** Upload unofficial transcripts, proof of degree (if available), and required supporting documents through your myInfo "Graduate Application" account.
- 7 **Check the status of your application:** Once we have assessed your application, your myInfo account status will be updated to reflect the decision. A formal letter will be sent to your Lakehead University email account (either a Letter of Acceptance or a refusal letter).
- 8 **Accept your Offer:** If you receive a Letter of Acceptance, you will also be emailed an "Admission Response Document." Please complete this document, scan it and email it back to us. You will also need to pay your confirmation deposit as instructed in your Offer email. The best way to pay deposits and fees is through Global Pay for Students.

Check your letter to verify the official documentation we require in our offices and send to:

**Lakehead University – Faculty of Graduate Studies**  
955 Oliver Road, Thunder Bay, Ontario, Canada P7B 5E1

For more details, visit: [lakeheadu.ca/international-fee-info](https://lakeheadu.ca/international-fee-info)

## INTAKE AND STUDY PERIODS

### SEPTEMBER - DECEMBER

Fall Semester

#### September

- Intake for all undergraduate and graduate academic programs
- Academic English Program intake
- Visiting International Student Program intake

### JANUARY - APRIL

Winter Semester

#### January

- Intake for limited undergraduate programs\* on a part-time basis†
- Intake for some graduate programs\*\*
- Academic English Program intakes
- Visiting International Student Program intake

### MAY - JUNE

Spring Semester

#### May

- Academic English Program intake
- Intake for limited undergraduate programs\* on a part-time basis†
- Intake for some graduate programs\*\*

### JULY - AUGUST

Summer Semester

#### July-August

- Intensive Academic English Program

\* Depending on course availability; students may not be able to take a full course load.  
\*\* Start terms for graduate programs are subject to change. For exceptions and up-to-date information, visit: [lakeheadu.ca/graduate-start-terms](https://lakeheadu.ca/graduate-start-terms)

† except Nursing, Consecutive Education, One-Year Honours Bachelor of Social Work, and all Lakehead-Georgian diploma+degree programs (Computer Science, Electrical Engineering, Applied Life Sciences, Environmental Sustainability)



ADMISSION REQUIREMENTS

UNDERGRADUATE ADMISSION REQUIREMENTS:

To be considered for admission to an undergraduate program at Lakehead University, we require:

- ▶ Successful graduation from an academic secondary school program or equivalent. For admission requirements by country, visit: [lakeheadu.ca/undergrad-requirements-by-country](https://lakeheadu.ca/undergrad-requirements-by-country)
- ▶ Canadian equivalent of a minimum 70%\* overall final average
- ▶ Depending on your program of study, program-specific prerequisite courses, visit: [lakeheadu.ca/undergrad-prerequisites](https://lakeheadu.ca/undergrad-prerequisites)

INTERNATIONAL BACCALAUREATE PROGRAM (IB) ADMISSION REQUIREMENTS:

International Baccalaureate Diploma Program applicants who achieve their diploma with a total score of at least 24 may be eligible for admission. Three Higher Level subjects must be completed. Prerequisite courses can be presented at either Standard Level or Higher Level. Meeting the minimum admission requirements does not guarantee admission. Some of our competitive programs may require a total score greater than 24.

Note: You may be considered for advanced standing credit in some higher level subjects provided a score of five (5) or better has been attained in the higher level subject.

ADVANCED PLACEMENT:

Advanced Placement courses and examinations may be used to determine admissibility and the granting of credit or exemption. If you have achieved a minimum grade of 4 on certain advanced placement exams, you may be eligible to receive university credit. Please note that Engineering programs are not eligible for AP transfer credit consideration. To be considered for transfer credit, you must have the College Board send your results directly to Lakehead University as soon as they are available.

BRITISH COLUMBIA CURRICULUM ADMISSION REQUIREMENTS:

If you have studied at a high school offering the British Columbia curriculum, you will need the following:

- ▶ Senior Secondary Graduation Diploma
- ▶ Minimum of four Grade 12 courses, including program-specific prerequisite courses
- ▶ Minimum 70%\* overall final average

Note: Academic courses do not have to be provincially-examinable courses, but if you decide to write the optional provincial examination, the higher of either (a) your course-only grade or (b) your blended course/ provincial examination grade will be used.

ONTARIO CURRICULUM ADMISSION REQUIREMENTS:

If you have studied at a high school offering the Ontario curriculum, you will need the following:

- ▶ Completion of the Ontario Secondary School Diploma (OSSD)
- ▶ A minimum of 6 Grade 12 U or M courses, or equivalent, including program-specific prerequisite courses
- ▶ A minimum 70%\* overall final average\*\*

UNITED STATES OF AMERICA (USA) ADMISSION REQUIREMENTS:

You will be considered for admission provided you:

- ▶ Achieve a minimum admission average of 70% based on your senior level (i.e. Grade 12) or equivalent courses
- ▶ Complete a minimum of four academic courses at the senior level or equivalent
- ▶ Satisfy the program specific prerequisites by completing academic courses at the senior level or equivalent
- ▶ Obtain your high school diploma from an accredited institution

Applicants are not required to complete an ACT or SAT.

\*Minimum 75% is required for the Applied Life Sciences and the Environmental Sustainability Lakehead-Georgian partnership programs. Higher averages may be required for admission to programs in which the demand for places by qualified applicants exceeds the supply of available spaces.  
\*\*Admission averages are calculated using the top 6 Grade 12 U or M courses, or equivalent.

BRITISH-PATTERNED EDUCATION ADMISSION REQUIREMENTS:

You will be considered for admission provided the following criteria are met:

1. Possess the (International) General Certificate of Secondary Education with:
  - i. Passes in at least five subjects:
    - ▶ Two of which must be at the Advanced Level (GCE)
    - ▶ Two subjects at the Advanced Supplementary (AS) Level may be substituted for one subject at the Advanced Level
    - ▶ The remaining three passes may be at the Ordinary Level (GCSE)
  - ii. Acceptable standing must be achieved in all subjects
2. Applicants may apply for admission in the year they will be sitting for their final A-Level examinations provided they can present excellent grades in their O-Level examinations and strong predicted A-Level results.
3. Excluding our Engineering programs, which require A-Level Mathematics, AS-Level Mathematics may satisfy the “Mathematics” prerequisite requirement; however, it depends on the papers (i.e. modules) completed. For example, most our of Science programs require Pure Mathematics 1 & 2 to be completed as part of AS-Level Mathematics.
4. Applicants presenting A-Level examinations with a minimum grade of “C” may be considered for advanced standing.
5. In addition to the above, applicants interested in the four-year Bachelor of Engineering degree program must complete the following prerequisite courses:
  - i. A-Level Mathematics
  - ii. A-Level Physics
  - iii. A-Level Chemistry is preferred; however, AS-level Chemistry will be accepted
  - iv. O-Level English
6. One of the following is required to meet the academic English prerequisite:

- ▶ A-Level Literature in English
- ▶ AS Level Literature in English
- ▶ O-Level Literature in English
- ▶ A-Level English Language
- ▶ AS Level English Language
- ▶ AS Level Language and Literature
- ▶ A-Level English as a Second Language (ESL)
- ▶ AS-Level ESL

We do not accept the following courses to meet the academic English prerequisite requirement:

- ▶ O-Level English Language
- ▶ O-Level First Language English
- ▶ O-Level ESL

GRADUATE ADMISSION REQUIREMENTS:

Our minimum admission requirement for consideration of international applicants is 75% or 3.0 on a 4 point Canadian scale, with an accredited university degree equivalent to a Lakehead University four-year degree. We advise all international students to apply early, as admission into our programs is competitive. Should you wish to apply to a thesis program, we strongly advise you to contact a potential supervisor and have your proof of English language proficiency complete. At this time, we do not pre-assess qualifications.

UNDERGRADUATE PROGRAM-SPECIFIC PREREQUISITES:

You must also satisfy Lakehead University’s program-specific prerequisites for your academic program of interest in order to be considered for admission. You must complete these prerequisite subjects at the senior/final year level. Visit: [lakeheadu.ca/undergrad-prerequisites](https://lakeheadu.ca/undergrad-prerequisites)

DEGREE:	PROGRAM & MAJORS:	PREREQUISITES:
Arts	Anthropology, Anthropology with Concurrent Education (P/J and I/S), English, English with Concurrent Education (P/J and I/S) (5-year accelerated option), English with Concurrent Education (P/J and I/S), English & History, English & History with Concurrent Education (I/S), English & Philosophy, English & Women’s Studies, General Arts, Geography, Geography with Concurrent Education (P/J and I/S), History, History with Concurrent Education (P/J and I/S), History with Concurrent Education (P/J and I/S) (5-year accelerated option), History & Philosophy, History & Political Science, History & Sociology, History & Women’s Studies, Indigenous Learning, Indigenous Learning & Philosophy, Indigenous Learning & Women’s Studies, Lakehead Arts One, Philosophy, Philosophy with Concurrent Education (P/J), Philosophy & Political Science, Political Science, Political Science – Pre-Law, Political Science and Women’s Studies, Psychology, Psychology with Concurrent Education (P/J and I/S), Psychology (Specialized Honours), Psychology (Specialized Honours with Major Concentration in Women’s Studies), Psychology & Philosophy, Psychology & Women’s Studies, Sociology, Sociology with Concurrent Education (P/J), Sociology & Women’s Studies, Lakehead Arts One, Lakehead Arts One with Concurrent Education (P/J and I/S) & Women’s Studies, Women’s Studies with Concurrent Education (P/J)	English
	Economics, Economics & Political Science	English; Math
	English & French, English & French with Concurrent Education (I/S), French, French with Concurrent Education (P/J and I/S), French & History, French & History with Concurrent Education (I/S), French & Philosophy	English; French
	Mathematics, Mathematics with Concurrent Education (P/J and I/S), Mathematics & Economics	English; Math
	Music*, Music with Concurrent Education (P/J and I/S)*	English; <i>An audition and theory entrance test is required to be considered for admission into the Music major.</i>
	Visual Arts, Visual Arts with Concurrent Education (P/J)	English
Arts & Science	Anthropology, Anthropology with Concurrent Education (P/J), Criminology, English, English with Concurrent Education (P/J), Environmental Sustainability (Co-op Available), Environmental Sustainability with Concurrent Education (P/J), Environmental Sustainability (Lakehead-Georgian), Geography, Geography with Concurrent Education (P/J), Interdisciplinary Studies, Interdisciplinary Studies with Concurrent Education (P/J), Interdisciplinary Studies with Concurrent Education (P/J) (5-year accelerated option), Interdisciplinary Studies with Concentrations in: Environment in Politics & Culture, Social Justice, International Conflict and Human Rights, and Human Nature, Interdisciplinary Studies with Concentrations in Environment in Politics & Culture, Social Justice, International Conflict and Human Rights, and Human Nature with Concurrent Education (P/J), Media, Film and Communications	English  For Environmental Sustainability (Lakehead-Georgian), both English and Math are required.
Business	Business Administration and Commerce (Co-op Available)	English; Math; Applicants without Math may be considered for admission but will be required to take a prescribed course as a first-year elective.
Concurrent Education	Concurrent Education is offered with a number of arts, arts & science, and science programs. You will see them listed throughout the chart. P/J - Primary/Junior (Kindergarten to Grade 6) I/S - Intermediate/Senior (Grades 7 to 12)	For prerequisites, please refer to the primary degree you would like to take alongside Concurrent Education.
	Aboriginal Education (P/J), Indigenous Learning (I/S)	English; <i>Proof of Indigenous ancestry may be required.</i>
Engineering	Chemical, Chemical + MBA, Civil, Civil + MBA, Electrical, Electrical + MBA, Mechanical, Mechanical + MBA, Software, Software + MBA, Electrical Engineering (Lakehead-Georgian) (Co-op Available for all Engineering programs)  <i>Note: these requirements are for High School applicants and do not apply to the Post Diploma Transfer Program</i>	English; Math; Chemistry; Physics; Note: A final grade of 60% (Canadian equivalent) is required in Math.
	Common Year in Applied Science (One-Year Upgrading Program)	English; Chemistry; Math; Physics
Environmental Management	Environmental Management (Co-op Available)	English; 3 subjects from: Biology, Chemistry, Computer Science, Geography, Math, or Physics

\* Higher averages may be required for admission to programs in which the demand for places by qualified applicants exceeds the supply of available spaces.  
Note: Where “Math” is indicated as a required course, the subject matter of that course must be equivalent to an Advanced Functions Math course.



DEGREE:	PROGRAM & MAJORS:	PREREQUISITES:
Environmental Science	Biology, Biology with Concurrent Education (I/S)	English; Math
	Earth Science	English; Math
	Geography, Geography with Concurrent Education (I/S)	English; Math
Environmental Studies	Geography, Geography with Concurrent Education (I/S)	English
Fine Arts	Visual Arts, Visual Arts with Concurrent Education (I/S)	English
Forestry	Forestry (Co-op Available)	English; 3 subjects from: Biology, Chemistry, Computer Science, Geography, Math, or Physics
Kinesiology	Kinesiology (Co-op Available), Kinesiology with Concurrent Education (P/J and I/S), Kinesiology with Concurrent Education (P/J and I/S) (5-year accelerated option requires final average of at least 75%)	English; Math; 2 from Biology, Chemistry, or Physics
Music	Music*	English; <i>An audition and theory entrance test is required to be considered for admission into the Music major.</i>
Nursing	Collaborative (4 Years)*, and Compressed (3 Years)*	English; Biology; Chemistry; Math <i>A minimum grade of 60% (Canadian equivalent) is required in each of the program specific prerequisites for both programs. A minimum final average of 80% (Canadian equivalent) is required for the Compressed program.</i>
Outdoor Recreation	Outdoor Recreation, Outdoor Recreation with Concurrent Education (P/J and I/S), Outdoor Recreation & BA (Geography), Outdoor Recreation & BA (History), Outdoor Recreation & BA (Women's Studies), Outdoor Recreation with Major Concentration in Nature-Based Therapeutic Recreation	English
	Outdoor Recreation & BSc (Natural Science)	English; 2 from: Biology, Chemistry, Earth & Space Science, Math, or Physics
Science	Anthropology, Anthropology with Concurrent Education (P/J and I/S), Applied Life Sciences, Applied Life Sciences with Major Concentration in Biomedical Sciences, Applied Life Sciences (Lakehead-Georgian), Biology, Biology with Concurrent Education (I/S), Biology with Concurrent Education (I/S) (5-year accelerated option), Biology with Major Concentration in Animal Sciences, Biodiversity and Conservation, Neuroscience or Plant Sciences, Geography, Geography with Concurrent Education (P/J and I/S), Geography with Geology Minor, Lakehead Science One, Mathematical Physics, Physics (Co-op Available), Physics with Concurrent Education (P/J and I/S), Physics with Major Concentration in Biomedical Physics	English; Math; 2 from: Biology, Chemistry, Earth & Space Science, Math (additional), or Physics  For Applied Life Sciences (Lakehead-Georgian): English; Math; Biology; Chemistry
	Bioinformatics	English; Biology; Chemistry; Math
	Biology & Chemistry, Biology & Chemistry with Concurrent Education (I/S), Chemistry, Chemistry with Concurrent Education (I/S and P/J) (5-year accelerated option for I/S), Chemistry with Specialization in Medical Sciences	English; Chemistry; Math; 1 Subject from: Biology, Math (additional), or Physics
	Computer Science (Co-op Available); Computer Science (Lakehead-Georgian)(Co-op Mandatory)	English; Math; 1 from: Computer Science, Math (additional), or Physics
	Earth Science, Earth Science with Concurrent Education (P/J and I/S), General Science, Geomorphology, Natural Science, Natural Science with Concurrent Education (P/J), Lakehead Science One, Lakehead Science One with Concurrent Education (P/J and I/S)	English; 2 from: Biology, Chemistry, Earth & Space Science, Math, or Physics  For Lakehead Science One: English, Math, 1 from: Biology, Chemistry, Computer Science, Earth & Space Science, Math (additional), or Physics
	Geology, Geology with Concurrent Education (I/S)	English; Math
	Mathematics, Mathematics with Concurrent Education (P/J and I/S), Mathematics & Physics	English; Math; 1 from: Biology, Chemistry, Math (additional), or Physics
	Psychology, Psychology (Specialized Honours), Psychology with Concurrent Education (I/S)	English; Math; 2 from: Biology, Chemistry, Math (additional), or Physics
	Resource & Environmental Economics	English; Math; 1 subject from: Biology, Chemistry, or Physics
	Water Resource Science, Water Resource Science Major Specialization in Applied Environmental Water Management	English; 3 subjects from: Biology, Chemistry, Math, or Physics
Social Work	Social Work, Social Work with Major Concentration in Indigenous Learning, Social Work with Major Concentration in Women's Studies	English

\* Higher averages may be required for admission to programs in which the demand for places by qualified applicants exceeds the supply of available spaces.  
 Note: Where "Math" is indicated as a required course, the subject matter of that course must be equivalent to an Advanced Functions Math course.

# ENGLISH LANGUAGE PROFICIENCY



YOUR PATHWAY TO  
DEGREE STUDIES

## ENGLISH LANGUAGE PROFICIENCY REQUIREMENTS:

You may meet our English language requirements if you have successfully completed (or are in the process of completing) three (3) years of full-time recent study in an English language school system. For graduate program applicants, these three years must be at the postsecondary level. If you do not meet the aforementioned requirement, you will be required to present proof of English language proficiency as follows:

- 1 Successful completion of one of the language tests with the required minimum scores (see right).
- 2 Successful completion of Lakehead University's Academic English Program.
- 3 Successful completion of one of our approved Pathway Partner's programs.



## ACADEMIC ENGLISH PROGRAM

If you do not meet the English language requirements for the academic program you have applied for, but meet all the other admission requirements, you may be admitted to your academic program on the condition of completing the Academic English Program (AEP) or Intensive Academic English Program (IAEP).

Undergraduate Applicants: If you have already been conditionally accepted to an Undergraduate Program, you do not need to apply separately for the Academic English Program (AEP).

Graduate Applicants: If you have already been accepted to a Graduate Level Program and need to take the Academic English Program (AEP), please apply using the Graduate Studies Academic English Program form that you will receive with your Conditional Letter of Acceptance.

If completing the Academic English Program (AEP) is a condition of your admission, and you don't have a current or valid IELTS or TOEFL score at the time of registration in the AEP, when you arrive at Lakehead you will complete a placement test to determine how many semesters (levels) of the AEP you require to meet your language condition. The Academic English Program (AEP) has five levels, from beginner to advanced. Each level is one semester (13 weeks) long. Upon completion of Level 5, you will have met the language condition for most undergraduate and graduate level programs offered at Lakehead University.

If you are being admitted to the Intensive Academic English Program (IAEP), you will have been instructed in your Letter of Acceptance to arrive in the summer to complete it before your academic program begins in September.

[lakeheadu.ca/aep](https://lakeheadu.ca/aep)

## COMMON ESL TESTS & MINIMUM SCORES

### IELTS - International English Language Testing

*System Applicants must complete the Academic test, not the General test.*

Minimum Score: 6.5 (no individual score less than 6.0)

For Nursing, Juris Doctor and Consecutive Education:  
Minimum Score: 7 (Minimum Individual Component Scores: Writing 7, Speaking 7, Reading 6.5, Listening 6.5)

### TOEFL (internet based)

Minimum Score: 80 (no component score less than 19)

For Nursing, Juris Doctor and Consecutive Education:  
Minimum Score: 103 (Minimum Individual Component Scores: Writing 28, Speaking 28, Reading 24, Listening 24)

Lakehead University's Institution Code for TOEFL scores is 0888.

### Cambridge Academic English Test

C1 Advanced or C2 Proficiency

Minimum Score: 176 (no individual score less than 169)

For Nursing, Juris Doctor and Consecutive Education:  
Minimum Overall Score: 185 (Minimum Individual Component Scores: Listening 176, Reading & Use of English 176, Speaking 185, Writing 185)

Applicants must provide us with their Candidate ID and Candidate Number.

Email them to: [intl.admission@lakeheadu.ca](mailto:intl.admission@lakeheadu.ca)

### PTE Academic - Pearson Test of English Academic

Minimum Score: 58 (no component score less than 50)

For Nursing, Juris Doctor and Consecutive Education:  
Minimum Overall Score: 65 (Listening 58, Reading 58, Speaking 65, Writing 65)

### CAEL - Canadian Academic English Language Assessment

#### CAEL - CE (Computer Edition)

Minimum Score: 60

NOTE: Some academic units may require a higher score. Meeting the minimum requirements does not guarantee admission to Lakehead University.



# ENGLISH LANGUAGE CENTRE

Lakehead University offers a wide variety of English language courses in order to help you meet your educational, professional and personal goals. From beginner to university level, we have a program that will get you there.

## ACADEMIC ENGLISH PROGRAM (AEP) T O

13 WEEKS PER LEVEL / 25 HOURS PER WEEK

## INTENSIVE ACADEMIC ENGLISH PROGRAM (IAEP) T O

9 WEEKS COMPRESSED SUMMER PROGRAM / 36 HOURS PER WEEK  
OVERALL IELTS SCORE OF 6.0 REQUIRED (NO INDIVIDUAL SCORE BELOW 6.0)

The Academic English Programs (AEP & IAEP) are designed to prepare students for future academic studies. If you do not meet the English language requirements for the academic program you have applied for, but meet all the other admission requirements, you may be admitted to your academic program on the condition of completing either the AEP or IAEP.

[lakeheadu.ca/aep](https://lakeheadu.ca/aep)

## IELTS PREPARATORY COURSE & TESTING T IELTS

4 WEEKS

Our IELTS Preparatory Course has 40 hours of instruction, offered intensively over two weeks or spread out over a four-week period. You will learn how to write the IELTS exam both effectively and successfully through in-class instruction, labs, and a unique IELTS online practice program new to Canada. Following the Preparatory Course, you may write the General or Academic IELTS exam at Lakehead University as well.

[lakeheadu.ca/ielts-testing-centre](https://lakeheadu.ca/ielts-testing-centre)

## VISITING INTERNATIONAL STUDENT PROGRAM (VIP) T O

4 MONTHS / 6 MONTHS

If you are a university student outside of Canada, visit Lakehead for four or six months to improve your English-language skills and take up to three academic courses for credit at the same time. For students with an IELTS of 5.5 or 6.0, the Visiting International Student Program complements English language and academic study with social and cultural excursions to give you the full Canadian experience. As a VIP student, you will have access to extensive student supports as well as to the English Language Centre Homestay Program.

[lakeheadu.ca/elc-vip](https://lakeheadu.ca/elc-vip)

### DATES

- ▶ January 11 - April 16, 2021 (AEP)
- ▶ May 3 - July 30, 2021 (AEP)
- ▶ September 6 - December 17, 2021 (AEP)
- ▶ June 28 - August 27, 2021 (IAEP)

AEP - Academic English Program

IAEP - Intensive Academic English Program



# MAPLE LEAF WORLD SCHOOLS

Complete or upgrade your high school credits prior to beginning your studies at Lakehead University at the Maple Leaf World School - LakeheadU.

## MAPLE LEAF WORLD SCHOOL - LAKEHEAD UNIVERSITY CAMPUS

The Maple Leaf university school model offers the best of both worlds—a university preparatory high school located on a university campus. Experience the support and community of small high school classes and a unique high school identity along with the independence and academic opportunities of learning on a university campus.

The Maple Leaf World School - LakeheadU campus allows you to complete the globally-respected Ontario Secondary School Diploma curriculum (grades 9 -12) within the Maple Leaf system that blends the best of western and eastern educational practices, promotes appreciation for the diversity of cultures, and inspires in its students the spirit and ideals of global citizenship.

Learn more: [lakeheadu.ca/mapleleafworldschool](https://lakeheadu.ca/mapleleafworldschool)



ACCELERATE YOUR LEARNING THROUGH COMBINED  
HIGH SCHOOL AND UNIVERSITY STUDIES

1:5

TEACHER STUDENT RATIO TO HELP  
TO ENSURE ACADEMIC SUCCESS

PATHWAY TO  
TOP GLOBAL  
UNIVERSITIES



WITH NO ADDITIONAL ENGLISH  
LANGUAGE PROFICIENCY TESTS

- ▶ **University facilities:** Access state-of-the-art university facilities including libraries, science laboratories, and sports facilities.
- ▶ **University pathway:** Maple Leaf Students have the pathway opportunity to Lakehead University with early admission while still in high school.
- ▶ **Dual credits:** Maple Leaf students have the opportunity to begin taking first year university courses at Lakehead University.
- ▶ **Experienced educators:** Our Principal and teachers are Ontario Certified Teachers, and many hold over 10 years of international education experience.
- ▶ **Boarding model:** Spacious and safe dormitory living for students only minutes away from class.
- ▶ **Meal plan:** Nutritious lunches and dinners are provided at the school.
- ▶ **After-school club and tutorial:** Our teachers are available after school each school day for questions and learning support.
- ▶ **Weekend activities:** Students have the opportunity to join bi-weekly weekend activities during the school year. The trips serve as a way to allow students to get out and explore the community. Past outings included sailing, attending sporting events, ziplining, dog sledding, skiing, fishing, and much more.
- ▶ **Mandarin course option:** Mandarin Language classes are offered as elective credits for all students. Mandarin as a second language courses are also available to those looking to learn a new language.







# CANADIANS ABROAD



## WELCOME HOME!

Continue your global education at Lakehead, where you can study with students from over 70 nations, benefit from the worldwide recognition and high calibre of the Canadian public university system, and access affordable Canadian tuition rates, generous scholarships, and bursaries.

### NEXT STOP: UNIVERSITY STUDIES IN CANADA

Lakehead University welcomes Canadian students who have graduated from recognized international high schools and institutions from around the world. Returning to Canada to embark on the next stage of your education is the perfect way to blend the best of Canadian university studies with your vast international experiences.

Lakehead University looks forward to welcoming you home, while helping you prepare for the future and your next great adventure.

[lakeheadu.ca/welcomehome](https://lakeheadu.ca/welcomehome)

### THE TRANSITION TO CANADA

As a Canadian expat living and studying abroad, you've experienced a unique education that goes beyond the classroom - you were an international student yourself! Returning to Canada, you'll become part of the "domestic" student community. Your international experiences and journey do not have to end now. We encourage you to stay connected with Lakehead University International, take part in events and activities, and consider volunteering as a Global Ambassador or join one of our many other activities and programs.

Learn more about Lakehead University International by visiting:

[lakeheadu.ca/international](https://lakeheadu.ca/international)

### ADMISSIONS FOR CANADIANS ABROAD

As a Canadian studying abroad, you will be assessed for admission to Lakehead University based on the program you have applied to and your international credentials and background. Your transcripts will be converted to Canadian equivalency for courses and grades earned, and then admission will be determined. For more information about your admissibility and questions relating to admissions, please contact:

#### Undergraduate Admissions

[intl.admission@lakeheadu.ca](mailto:intl.admission@lakeheadu.ca)

[lakeheadu.ca/undergraduate-admissions](https://lakeheadu.ca/undergraduate-admissions)

#### Graduate Admissions

[gstudent@lakeheadu.ca](mailto:gstudent@lakeheadu.ca)

[lakeheadu.ca/graduate-applications](https://lakeheadu.ca/graduate-applications)

### UNDERGRADUATE ENTRANCE SCHOLARSHIPS FOR CANADIANS

*Automatic - No scholarship application required*

Rewarding exceptional academic performance, we guarantee funding to entering high school students who are Canadian citizens studying at a high school in Canada and who have a minimum 80% average from a recognized Canadian high school curriculum.

[lakeheadu.ca/studentcentral/financing-budgeting](https://lakeheadu.ca/studentcentral/financing-budgeting)

[myAwards.lakeheadu.ca](https://myAwards.lakeheadu.ca)

Academic Average (Canadian Equivalent)		Scholarship Total <sup>1</sup> (Value Per Year)
95.0% & OVER	=	<b>FREE TUITION</b> (Tuition x 4 years) <sup>*1</sup>
90.0% - 94.9%	=	<b>\$10,000 CAD</b> (\$2,500 x 4 years) <sup>2</sup>
85.0% - 89.9%	=	<b>\$5,000 CAD</b> (\$1,250 x 4 years) <sup>2</sup>
80.0% - 84.9%	=	<b>\$3,000 CAD</b> (\$750 x 4 years) <sup>2</sup>

\* Free Tuition Scholarship is based on final top 6 Grade 12 U/M marks or equivalent. If your final scholarship average decreases below 95%, a \$4,000 renewable Scholarship will be awarded. See <sup>1</sup> for \$4,000 renewal criteria.

1 Free Tuition Scholarship and \$4,000 Scholarship renewable provided a 90% average is achieved in each academic year. If your university academic average falls between 80.0% - 89.9%, you will receive an amended scholarship valued at \$2,500/year for each subsequent academic year for the remaining term of the scholarship.

2 Renewable provided an 80% average is achieved in each academic year.

### UNDERGRADUATE ENTRANCE BURSARIES FOR CANADIANS

- ▶ Our entrance bursary program provides over \$300,000 CAD annually for Canadian students who demonstrate financial need.
- ▶ General & Travel Bursary - Up to \$2,300 CAD
- ▶ Travel Bursary portion of \$800 CAD is based on living distance from the Thunder Bay or Orillia Campus (must be over 700 km away)
- ▶ Application Deadline: Round 1 - April 15, 2021; Round 2 - June 30, 2021

### UNDERGRADUATE PRESIDENTIAL SCHOLARSHIPS FOR CANADIANS

- ▶ Value: Up to 2 X \$30,000 (\$7,500/Year for 4 years)
- ▶ Awarded to outstanding Canadian high school students annually who have achieved a minimum 90% average and have demonstrated leadership qualities and made significant contributions to their high school and their community.
- ▶ Application Deadline: April 24, 2021

### GRADUATE SCHOLARSHIPS & FUNDING FOR CANADIANS

As a full-time Canadian (domestic) graduate student at Lakehead University, you have the opportunity to apply for several scholarships, awards, bursaries and graduate assistantships throughout the academic year. Visit the graduate funding website regularly for funding opportunities.

[lakeheadu.ca/graduate-funding](https://lakeheadu.ca/graduate-funding)

[myAwards.lakeheadu.ca](https://myAwards.lakeheadu.ca)

### TUITION & FEES FOR CANADIANS

As a Canadian citizen studying abroad, when you return to Canada for your university studies, you will be able to take advantage of and qualify for domestic tuition rates and fees.

[lakeheadu.ca/tuition-fees](https://lakeheadu.ca/tuition-fees)

	Undergraduate 1 academic year (2 semesters/8 months)	Graduate 1 academic year (3 semesters/12 months)
Tuition <sup>1</sup>	\$5,984.51 - \$7,707.89 CAD	\$8,084.88 - \$13,474.77 CAD MBA: \$18,557.10 - \$23,505.66 CAD <sup>2</sup>
Ancillary Fees	\$934.51 - \$1,327.13 CAD	\$737.73 CAD

Amounts are in Canadian dollars and reflect the 2020-2021 regular academic year prices.

1 Tuition varies by program. All Graduate students are required to register and pay for three terms per year, until graduation.

2 First amount reflects the cost for the 12-month MBA, and the second for the 16-month MBA.

### COSTS OF UNIVERSITY FOR CANADIANS

As a Canadian citizen, you will have access to all the resources and supports that every student has, as well as the preferred funding rates of domestic students. Overall, ancillary costs, residence rates, etc. are the same for both Canadian and international students, but there is a difference in tuition rates and scholarships and bursaries for Domestic students:

For more information about fees and financing your education, please visit:

#### Undergraduate:

[lakeheadu.ca/studentcentral/financing-budgeting](https://lakeheadu.ca/studentcentral/financing-budgeting)

#### Graduate:

[lakeheadu.ca/graduate-funding](https://lakeheadu.ca/graduate-funding)







# DISCOVER LAKEHEAD

## THUNDER BAY CAMPUS

## WHERE'S WOLFIE?

Lakehead's Mascot, Wolfie, is hiding in this book. Can you find him? Spot him for a chance to win a Lakehead prize pack!

Learn how to win at:  
[lakeheadu.ca/whereswolfie](http://lakeheadu.ca/whereswolfie)



## THUNDER BAY CAMPUS LEGEND

- |   |  |   |                              |
|---|--|---|------------------------------|
| 1 Prettie Residence                           | AT Advanced Technology & Academic Centre                         | HF The Centre of Education and Research of Positive Youth Development | PH Power House               |
| 2 Bartley Residence                           | BB Braun Building  | HS Balmoral Street Centre   | RB Ryan Building             |
| 3 Townhouse Residences (Deer Lake Ridge)      | BL Bora Laskin Building  | IC International Centre   | RC Regional Centre           |
| 4 Student Apartments (North Residence)        | BS Bike Shelter  | LI Chancellor Paterson Library  | RL Lot 5 Research Lab        |
| 5 Student Apartments (South Residence)        | CB William Tamblin Centennial Building                           | MS NOSM - Northern Ontario School of Medicine                         | SB Sanders Fieldhouse        |
| 6 Halliday Hall Residence                     | FB CASES - Centre for Advanced Studies in Engineering & Sciences | MV Music and Visual Arts Centre                                       | SC Student Centre            |
| 7 Townhouse Residences (North Spirit Heights) | FL Fire Lab  | ND Nanabijou Childcare Centre   | SH Sanders Hangar            |
| 8 Townhouse Residences (Bearskin Lake)        | GH Greenhouse  | ND Alumni House -1294 Balmoral Street                                 | SN School of Nursing         |
| AC Avila Centre                               |  |   | UC University Centre (Agora) |

## CONTACT US



Take a Virtual Campus Tour  
or Book a Campus Tour  
[lakeheadu.ca/tours](http://lakeheadu.ca/tours)

## LAKEHEAD UNIVERSITY - INTERNATIONAL ENROLMENT

- 955 Oliver Road, Thunder Bay  
Ontario, Canada P7B 5E1
- +1 (807) 346-7859
- [welcome@lakeheadu.ca](mailto:welcome@lakeheadu.ca)
- LakeheadInternational
- LakeheadInternational
- LakeheadUniversity

## OUR GLOBAL OFFICES

**CANADA & USA**  
Toronto, Canada  
[toronto.office@lakeheadu.ca](mailto:toronto.office@lakeheadu.ca)

**CHINA**  
Beijing, China  
[china.office@lakeheadu.ca](mailto:china.office@lakeheadu.ca)

**INDIA**  
Delhi, India  
[india.office@lakeheadu.ca](mailto:india.office@lakeheadu.ca)

**MEXICO**  
Mexico City, Mexico  
[mexico.office@lakeheadu.ca](mailto:mexico.office@lakeheadu.ca)

**SOUTH EAST ASIA**  
Kuala Lumpur, Malaysia  
[seasia.office@lakeheadu.ca](mailto:seasia.office@lakeheadu.ca)

**CENTRAL & SOUTH AMERICA**  
Thunder Bay, Canada  
[latam.office@lakeheadu.ca](mailto:latam.office@lakeheadu.ca)

**MIDDLE EAST, AFRICA, CARIBBEAN**  
Thunder Bay, Canada  
[global.office@lakeheadu.ca](mailto:global.office@lakeheadu.ca)

**VIETNAM**  
Ho Chi Minh City, Vietnam  
[vietnam.office@lakeheadu.ca](mailto:vietnam.office@lakeheadu.ca)

## ORILLIA CAMPUS

## ORILLIA CAMPUS LEGEND

- OA Orillia Academic Building
- OC Cafeteria/Bookstore
- OR Residence & Conference Centre



# PROGRAMS

## ENGLISH LANGUAGE CENTRE

PROGRAMS	PAGE
Academic English Program (AEP)	<a href="#">T</a> <a href="#">O</a> 56
Intensive Academic English Program (IAEP)	<a href="#">T</a> <a href="#">O</a> 56
IELTS Preparatory Courses and Testing	<a href="#">T</a> 56
Visiting International Student Program (VIP)	<a href="#">T</a> <a href="#">O</a> 56
English Innovation Program (EIP)	<a href="#">T</a> <a href="#">O</a>
Customized Programs	<a href="#">T</a> <a href="#">O</a>

## UNDERGRADUATE PROGRAMS

PROGRAMS	PAGE
<b>BUSINESS ADMINISTRATION</b>	<b>34</b>
<b>HONOURS BACHELOR OF COMMERCE (4 YR)</b>	
Accounting ♦	<a href="#">T</a>
Business Administration ♦	<a href="#">O</a>
Business Economics	<a href="#">T</a>
Finance ♦	<a href="#">T</a>
General Management	<a href="#">T</a>
Global Entrepreneurship ♦	<a href="#">O</a>
Human Resources Management/Industrial Relations ♦	<a href="#">T</a>
Information Systems ♦	<a href="#">T</a>
International Business	<a href="#">T</a>
Marketing ♦	<a href="#">T</a>
<b>BACHELOR OF ADMINISTRATION (3 YR)</b>	
Administration	<a href="#">T</a> <a href="#">O</a>
Administration (Management)	<a href="#">O</a>
<b>ENGINEERING</b>	<b>36</b>
Chemical Engineering ♦	<a href="#">T</a>
Civil Engineering ♦	<a href="#">T</a>
Electrical Engineering ♦	<a href="#">T</a> <a href="#">LG</a>
Mechanical Engineering ♦	<a href="#">T</a>
Software Engineering ♦	<a href="#">T</a>
Optional joint BEng+MBA ♦ offered with all undergraduate Engineering programs at the Thunder Bay campus	<a href="#">T</a>
<b>EDUCATION</b>	<b>41</b>
Consecutive Education (2 yr BEd after Honours or Bachelor degree)	<a href="#">T</a> <a href="#">O</a>
Concurrent Education (4 yr HBA / HBSc + 2 yr BEd)	<a href="#">T</a> <a href="#">O</a>
<b>HEALTH &amp; BEHAVIOURAL SCIENCES</b>	<b>44</b>
Kinesiology ♦	<a href="#">T</a>
Nursing	<a href="#">T</a>
Psychology	<a href="#">T</a>
Social Work	<a href="#">T</a> <a href="#">O</a>
<b>NATURAL RESOURCES MANAGEMENT</b>	<b>40</b>
Environmental Management ♦	<a href="#">T</a>
Forestry ♦	<a href="#">T</a>

<b>SCIENCE &amp; ENVIRONMENTAL STUDIES</b>	<b>38</b>
Anthropology	<a href="#">T</a> <a href="#">O</a>
Applied Life Sciences	<a href="#">T</a> <a href="#">O</a> <a href="#">LG</a>
Bioinformatics	<a href="#">T</a>
Biology	<a href="#">T</a>
Chemistry	<a href="#">T</a>
Computer Science ♦	<a href="#">T</a> <a href="#">LG</a>
Earth Science	<a href="#">T</a>
Economics	<a href="#">T</a>
Environmental Science	<a href="#">T</a>
Environmental Studies	<a href="#">T</a>
Environmental Sustainability ♦	<a href="#">O</a> ♦ <a href="#">LG</a>
General Science	<a href="#">T</a> <a href="#">O</a>
Geoarchaeology	<a href="#">T</a>
Geography & the Environment	<a href="#">T</a> <a href="#">O</a>
Geology	<a href="#">T</a>
Lakehead Science One	<a href="#">T</a> <a href="#">O</a>
Mathematics	<a href="#">T</a>
Mathematical Physics	<a href="#">T</a>
Natural Science	<a href="#">T</a>
Physics ♦	<a href="#">T</a>
Resource & Environmental Economics	<a href="#">T</a>
Water Resource Science	<a href="#">T</a>
<b>SOCIAL SCIENCES &amp; HUMANITIES</b>	<b>42</b>
Criminology	<a href="#">O</a>
English	<a href="#">T</a> <a href="#">O</a>
General Arts	<a href="#">T</a> <a href="#">O</a>
History	<a href="#">T</a> <a href="#">O</a>
Indigenous Learning	<a href="#">T</a>
Interdisciplinary Studies	<a href="#">O</a>
Lakehead Arts One	<a href="#">T</a>
Languages	<a href="#">T</a>
Media, Film & Communications	<a href="#">O</a>
Music	<a href="#">T</a>
Outdoor Recreation, Parks & Tourism	<a href="#">T</a>
Philosophy	<a href="#">T</a>
Political Science (Pre-Law option available)	<a href="#">T</a> <a href="#">O</a>
Sociology	<a href="#">T</a> <a href="#">O</a>
Visual Arts	<a href="#">T</a>
Women's Studies	<a href="#">T</a>

## GRADUATE PROGRAMS

<b>MASTERS PROGRAMS</b>	<b>PAGE</b>
<b>BUSINESS</b>	<b>34</b>
Business Administration (MBA) (12 or 16 month)*	<a href="#">T</a>
Business Management (MScMgt)	<a href="#">T</a>
Business Skills Development Program (GMAT Equivalent for Admission)	<a href="#">T</a>
<b>ENGINEERING</b>	<b>36</b>
Chemical Engineering	<a href="#">T</a>
Civil Engineering ♦*	<a href="#">T</a>
Electrical and Computer Engineering ♦*	<a href="#">T</a>
Environmental Engineering ♦*	<a href="#">T</a>
Mechanical Engineering ♦*	<a href="#">T</a>
<b>EDUCATION</b>	<b>41</b>
Master of Education*	<a href="#">T</a>
<b>HEALTH &amp; BEHAVIOURAL SCIENCES</b>	<b>44</b>
Health Sciences	<a href="#">T</a>
Kinesiology	<a href="#">T</a>
Psychology: Clinical	<a href="#">T</a>
Psychology: Psychological Science	<a href="#">T</a>
Public Health*	<a href="#">T</a>
Social Work	<a href="#">T</a>
Gerontology & Nursing Specializations Available	<a href="#">T</a>
<b>NATURAL RESOURCES MANAGEMENT</b>	<b>40</b>
Science in Forestry*	<a href="#">T</a>
<b>SCIENCE &amp; ENVIRONMENTAL STUDIES</b>	<b>38</b>
Archaeological Sciences	<a href="#">T</a>
Biology	<a href="#">T</a>
Chemistry	<a href="#">T</a>
Computer Science*♦	<a href="#">T</a>
Economics*♦	<a href="#">T</a>
Geology	<a href="#">T</a>
Mathematical Sciences*	<a href="#">T</a>
Environmental Studies	<a href="#">T</a>
Physics	<a href="#">T</a>
<b>SOCIAL SCIENCES &amp; HUMANITIES</b>	<b>42</b>
English*	<a href="#">T</a>
History*	<a href="#">T</a>
Social Justice*	<a href="#">T</a>
Sociology	<a href="#">T</a>
Women's Studies Specializations Available	<a href="#">T</a>
<b>DOCTORAL PROGRAMS</b>	
<b>ENGINEERING</b>	<b>36</b>
Doctor of Philosophy in Engineering (Electrical & Computer)	<a href="#">T</a>
<b>HEALTH &amp; BEHAVIOURAL SCIENCES</b>	<b>44</b>
Doctor of Philosophy Clinical Psychology	<a href="#">T</a>
Doctor of Philosophy Health Sciences	<a href="#">T</a>
Doctor of Philosophy Psychological Science	<a href="#">T</a>
<b>EDUCATION</b>	<b>41</b>
Doctor of Philosophy in Educational Studies	<a href="#">T</a>
<b>NATURAL RESOURCES MANAGEMENT</b>	<b>40</b>
Doctor of Philosophy in Forest Sciences	<a href="#">T</a>
<b>SCIENCE &amp; ENVIRONMENTAL STUDIES</b>	<b>38</b>
Doctor of Philosophy in Chemistry and Materials Science	<a href="#">T</a>
Doctor of Philosophy in Biotechnology	<a href="#">T</a>

[T](#) Thunder Bay Campus [O](#) Orillia Campus [LG](#) Lakehead-Georgian

♦ Co-operative Education offered \*These Masters programs offer a course-based option.

Note: Programs are subject to change without prior notice.